

POLE AND EQUIPMENT SCHEDULE											
POLE No.	TYPE OF POLE	LUMINAIRE VOLTAGE/WATTAGE	VEHICLE SIGNAL					PEDESTRIAN SIGNAL			REMARKS
			No.	TYPE	MOUNTING	VISORS	LOUVERS	No.	TYPE	MOUNTING	
①	CITY STANDARD STREET LIGHT	200W HPS						28	1S-COUNT	SP-1	APS
②	1-A (10')		42	3S12"	TV-1-T	T		89	1S-COUNT	SP-1	APS
③	CITY STANDARD STREET LIGHT		41	3S12"	SV-1-T	T					APS MOUNT SIGNAL 41 AT 11'
④	27-3-100 W/40' MAST ARM		62 64 67	3S12" 3S12" 3S12"	SV-1-T MAS MAS	T T T		29	1S-COUNT	SP-1	BACKPLATE BACKPLATE
⑤	PPB POLE										APS
⑥	1-A (15')		61	3S12"	SV-1-T AT 45 DEGREES	T		68	1S-COUNT	SP-1-SF(12")	MOUNT SIGNAL 61 AT 10'.
⑦	CITY STANDARD STREET LIGHT							88 69	1S-COUNT 1S-COUNT	SP-1 (22") SP-1-SF(12")	APS
⑧	PPB POLE										APS

INTERCONNECT PLAN DETAIL
NOT TO SCALE

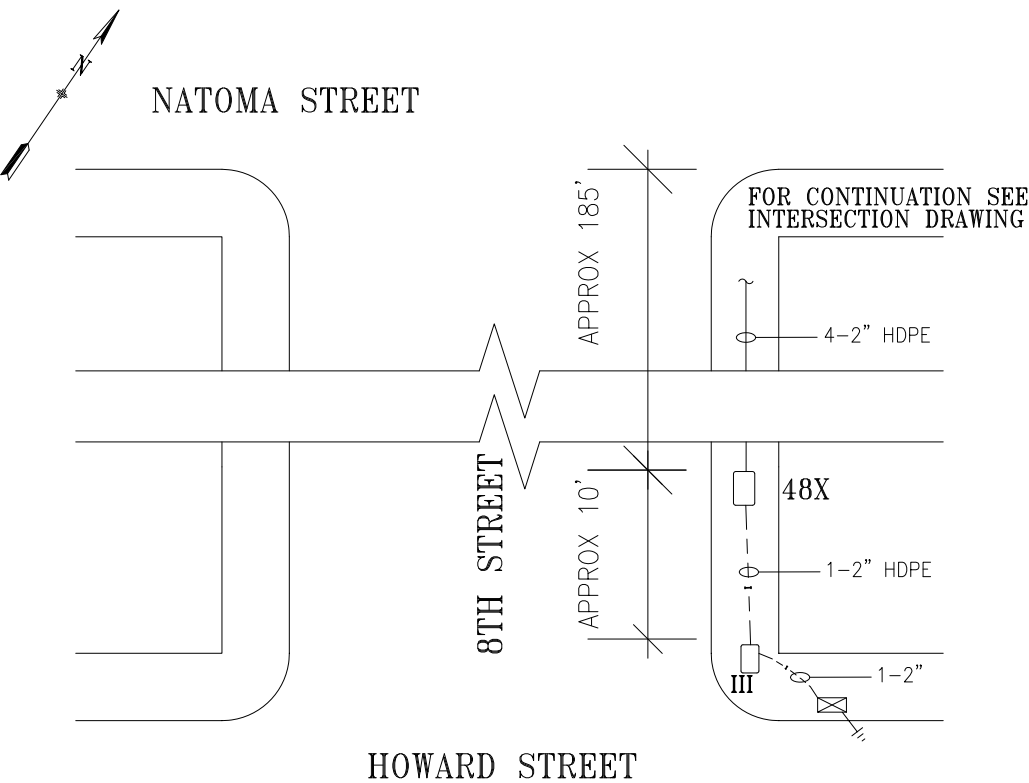

NO.		DATE	DESCRIPTION	BY	APP.
0	7/29/16	NEW SIGNAL ACTIVATED THROUGH #2477J	DYeung	GDeLeon	
TABLE OF REVISIONS CHECK WITH TRACING TO SEE IF YOU HAVE LATEST REVISION					

REFERENCE INFORMATION
& FILE NO. OF SURVEYS



SAN FRANCISCO MUNICIPAL TRANSPORTATION AGENCY
CITY AND COUNTY OF SAN FRANCISCO

DRAWN:	DATE:
AScales	6/19/2018
CHECKED:	DATE:
GDeLeon	8/27/2018

SCALE:

AS SHOWN

SHEET OF SHEETS

1 OF 1

TRAFFIC SIGNAL INVENTORY DIAGRAM

8TH STREET AND NATOMA STREET

CNN NO.

24302000

REV NO.

0