

Signal Cutover: 11/8/07
David Valle Scholt

DETAIL NOTES:

- A4 R/C EXISTING WIRING AND ABANDON CONDUIT. REPAIR SIDEWALK TO MATCH EXISTING INCLUDING FINISH PAVEMENT.
- A5 EX CONDUIT AND WIRING. R/C EX WIRING. CUT CONDUIT FLUSH TO PULL BOX WALL OR 12" DEPTH, CAP OR DUCT SEAL END(S).
- B6 EX CONDUIT AND 12/C TO REMAIN.
- H5 CONTRACTOR TO CALL US POSTAL SERVICES AT 1-800-222-1811 OR 284-0755 FOR RELOCATION OF MAIL BOX.
- I EXTEND 12/C INTERCONNECT TO NEW IC LOCATION. SPLICE TO EX 12/C TO MAINTAIN INTERCONNECT SYSTEM.
- L F/I IN-LINE FUSE HOLDER WITH 40A FUSE FOR IC SERVICE. SPLICE NEW WIRES TO EX PG&E SERVICE TO SUPPORT NEW IC.
- X1 RELOCATE (E) MUNI OPTICAL SIGNAL PROCESSOR FROM (E) IC TO (N) IC LOCATION.
- X3 F/I WITH INTEGRAL BALLAST AND PHOTOELECTRIC CONTROL. F/I FUSE AND FUSE HOLDERS PER SFPDW #49,092.

PHASE DIAGRAM

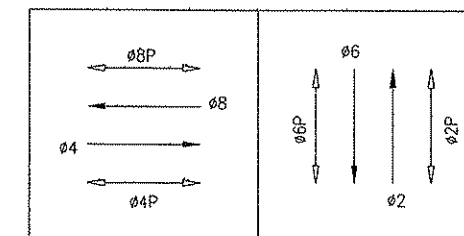

PHASE SEQUENCE

G	Y	R	MISSION (NB AND SB)	
R		G	Y	R
WM	FRH	RH		19TH STREET (EB AND WB)
RH	WM	FRH	RH	PEDS XING 19TH STREET (E/S AND W/S)
				PEDS XING MISSION (N/S AND S/S)

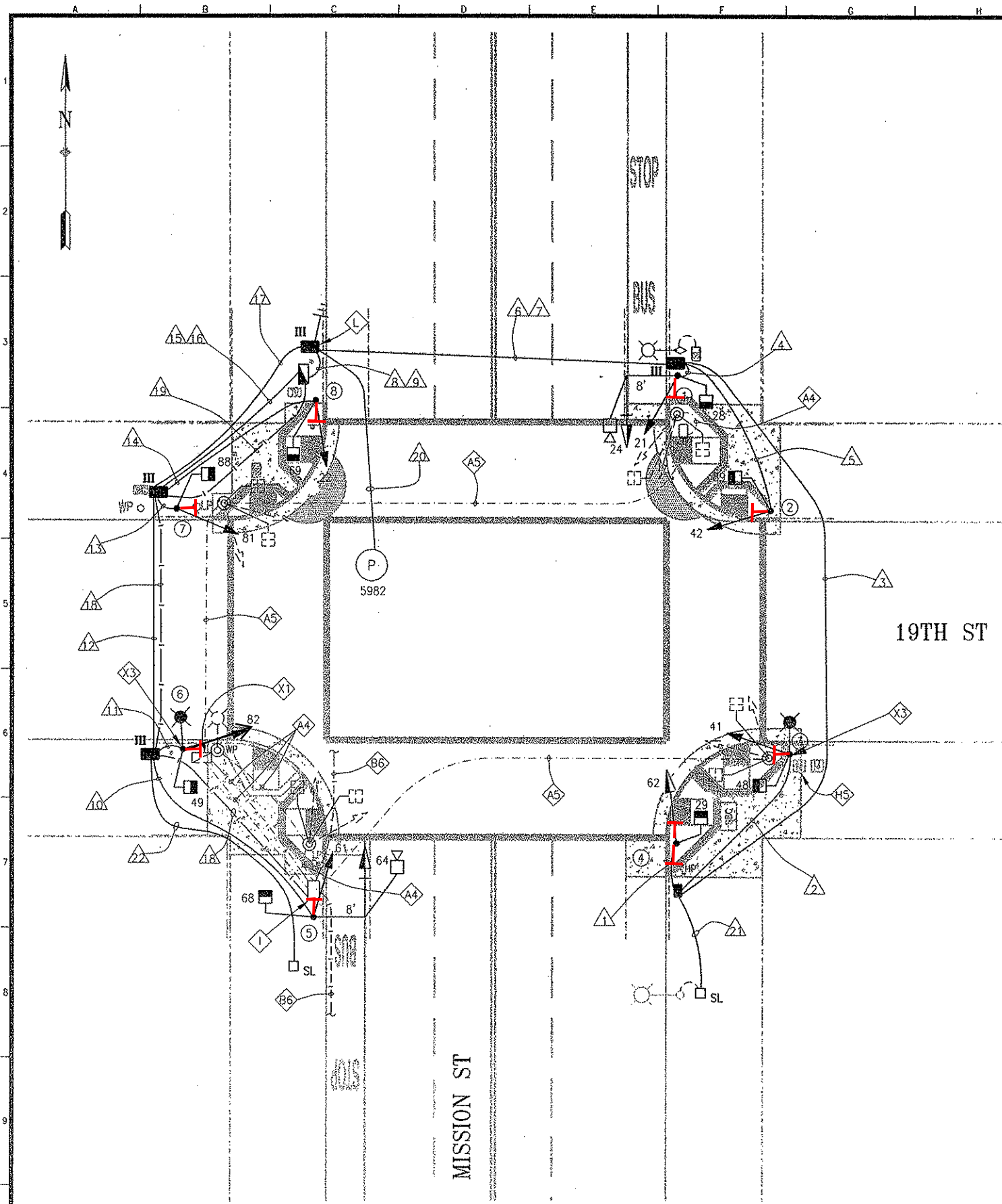

NO.	DATE	DESCRIPTION	BY	APP.
2	11/22/21	Install APS per SRC 2021-054. Per Field: 62 to 3S12"	E. Luu	G. DeLeon
1	5/11/21	Head 82 upgraded to 3S12"; mounted at 15' on street side	BBD	

TABLE OF REVISIONS
CHECK WITH TRACING TO SEE IF YOU HAVE LATEST REVISION

REFERENCE INFORMATION
& FILE NO. OF SURVEYS

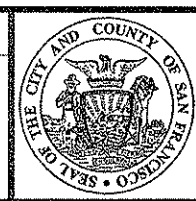

BUREAU OF ENGINEERING
DEPARTMENT OF PUBLIC WORKS
CITY AND COUNTY OF SAN FRANCISCO

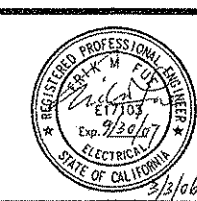

DESIGNED:	DATE:	APPROVED:	DATE:
EF/ET	10/05	<i>Neela</i>	3/3/06
DRAWN:	DATE:	SECTION MANAGER:	DATE:
RT	10/05	<i>Sanjay</i>	7/3/05
CHECKED:	DATE:	DEPUTY BUREAU MANAGER:	DATE:
BC	10/05	<i>Neela</i>	3/6/06
		CITY ENGINEER:	DATE:

SCALE:
1" = 10'
SHEET OF SHEETS
24 OF 56

MISSION STREET
TRAFFIC SIGNALS IMPROVEMENT
19TH ST AND MISSION ST

SPECIFICATION NO.	0944J (R)
DRAWING NO.	E-6.0
FILE NO.	86,289
REV. NO.	2

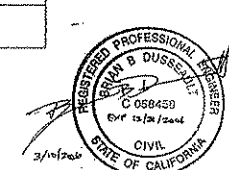

Drawing Path: V:\0944J Mission Street Traffic Signals Improvement (14th to 26th)\2.Design\Working\Drawings\00 Bond dwg\BOE Title B
Plot Time: Thu, 02 Mar 2006 - 7:58am
Measurement Units are English
Model Units: Feet
V:\0944J Mission Street Traffic Signals Improvement (14th to 26th)\2.Design\Working\Drawings\00 Bond dwg\BOE Title B
V:\0944J Mission Street Traffic Signals Improvement (14th to 26th)\2.Design\Working\Drawings\00 Bond dwg\BOE Title B

POLE AND EQUIPMENT SCHEDULE								CONTRACT WORK IN BOLD			
POLE No.	TYPE OF POLE	LUMINAIRE (HPS)	VEHICLE SIGNAL					PEDESTRIAN SIGNAL			REMARKS
		VOLTAGE/ WATTAGE	No.	TYPE	MOUNTING	VISORS	LOUVERS	No.	TYPE	MOUNTING	
①	16-1-70 W/ 8' MAST ARM		24 21	3S12" 3S8"	MAS SV-1-T	T T		28	1S-COUNT	SP-1	BP APS-3W TSP equipment
②	1-A (10')		42	3S8"	TV-1	T		89	1S-COUNT	SP-1	APS-3W
③	STANDARD CITY STREET LIGHT	120V/ 150W	41	3S8"	SV-1-T	T		48	1S-COUNT	SP-1	APS-3W
④	1-A (10')		62	3S12"	TV-1 -T	T		29	1S-COUNT	SP-1	APS-3W x 2
⑤	16-1-70 W/ 8' MAST ARM		64 61	3S12" 3S8"	MAS SV-1-T	T T		68	1S-COUNT	SP-1	BP APS-3W
⑥	STANDARD CITY STREET LIGHT	120V/ 150W	82	3S12"	SV-1-T (36" NIPPLE)	T		49	1S-COUNT	SP-1	Signal 82 mounted on street side @15' APS-3W
⑦	1-A (10')		81	3S8"	TV-1	T		88	1S-COUNT	SP-1	APS-3W
⑧	1-A (10')		22	3S8"	TV-1	T		69	1S-COUNT	SP-1	APS-3W

2	11/22/21	Install APS per SRC 2021-054. Per Field: 62 to 3S12"	E.Luu	G.DeLeon
1	5/11/21	Head 82 upgraded to 3S12"; mounted at 15' on street side	BBD	
NO.	DATE	DESCRIPTION	BY	APP.
TABLE OF REVISIONS				
CHECK WITH TRACING TO SEE IF YOU HAVE LATEST REVISION				

REFERENCE INFORMATION & FILE NO. OF SURVEYS
--



BUREAU OF ENGINEERING
DEPARTMENT OF PUBLIC WORKS
CITY AND COUNTY OF SAN FRANCISCO



DESIGNED: DATE:	10/05
DRAWN: DATE:	10/05
CHECKED: DATE:	10/05

APPROVED	10/05
SECTION MANAGER	
DEPUTY BUREAU MANAGER	11/14/05
CITY ENGINEER	11/14/05

SCALE:	NONE
SHEET OF SHEETS	25 OF 56

MISSION STREET TRAFFIC SIGNALS IMPROVEMENT
19TH ST AND MISSION ST SCHEDULE

SPECIFICATION NO.	0944J (R)
DRAWING NO.	E-6.1
FILE NO.	86,290
REV. NO.	2

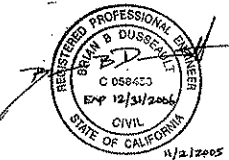

Drawing Path: V:\0944J Mission Street Traffic Signals Improvement (14th to 26th)\2-Design\Working Drawings\EEL\100 Bond dwgs\0944J Mission.dwg
Plot Time: Thu, 20 Oct 2005 - 1:51pm
Model Units: Feet
Measurement Units are English

