



POLE AND EQUIPMENT SCHEDULE											
POLE No.	TYPE OF POLE	LUMINAIRE VOLTAGE/ WATTAGE	VEHICLE SIGNAL					PEDESTRIAN SIGNAL			REMARKS
			No.	TYPE	MOUNTING	VISORS	LOUVERS	No.	TYPE	MOUNTING	
①	1-A (15')		22 65		TOP-MOUNT						PEDESTRIAN PUSH BUTTON
②	CITY STANDARD STREETLIGHT										PEDESTRIAN PUSH BUTTON
③	1-A (15')		25 62		TOP-MOUNT						PEDESTRIAN PUSH BUTTON
④	CITY STANDARD STREETLIGHT										PEDESTRIAN PUSH BUTTON

SHEET NOTES:

◇1 JSF TECHNOLOGIES AB-9407 AC DUAL SIDED RECTANGULAR RAPID FLASH BEACON ASSEMBLY

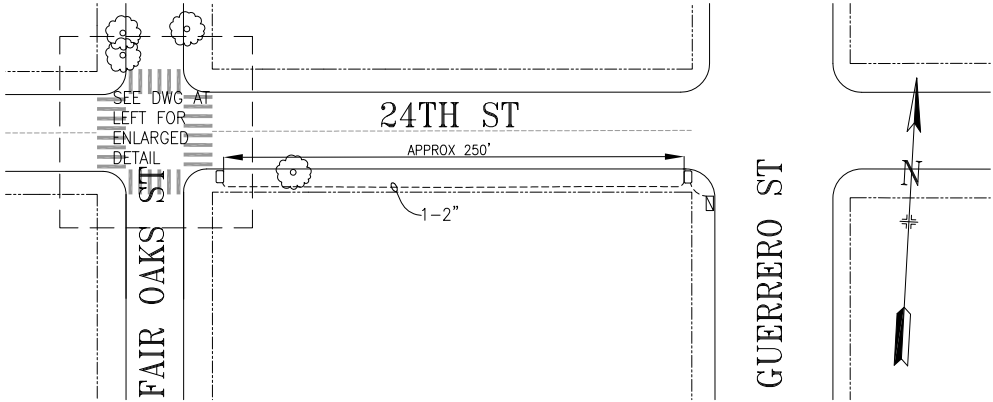

ELECTRICAL SERVICE PLAN DETAIL ①
NOT TO SCALE

TABLE OF REVISIONS				
NO.	DATE	DESCRIPTION	BY	APP.
0	11/12/2014	ACTIVATED THRU 22461; CONVERTED FROM CONTRACT PLANS	JH	MV
CHECK WITH TRACING TO SEE IF YOU HAVE LATEST REVISION				

REFERENCE INFORMATION & FILE NO. OF SURVEYS



SAN FRANCISCO MUNICIPAL TRANSPORTATION AGENCY

CITY AND COUNTY OF SAN FRANCISCO

DRAWN:	DATE:
JH	08/15
CHECKED:	DATE:
MV	08/15

SCALE:
AS SHOWN
SHEET OF SHEETS
1 OF 1

TRAFFIC SIGNAL INVENTORY DIAGRAM
24TH AND FAIR OAKS STREETS

CNN NO.
25605000
REV NO.
0