

FLASH 6/27/2019 (2:30PM)

SFMTA

Wei Sheng Zhang  
Robert Donohoe  
Steven Wong  
Stephanie Chan

3-COLOR 6/30/2019 (1:15PM)

SFMTA

Wei Sheng Zhang  
Alan Coughlan

DESIGN OF THE INTERCITY BUS FACILITY,  
NATOMA EXTENSION, UTILITY CONNECTIONS,  
AND ALL SURFACE WORK ASSOCIATED WITH  
TCC "MAIN STREET EXTENSION" IS ON HOLD  
AND NOT ISSUED FOR CONSTRUCTION.

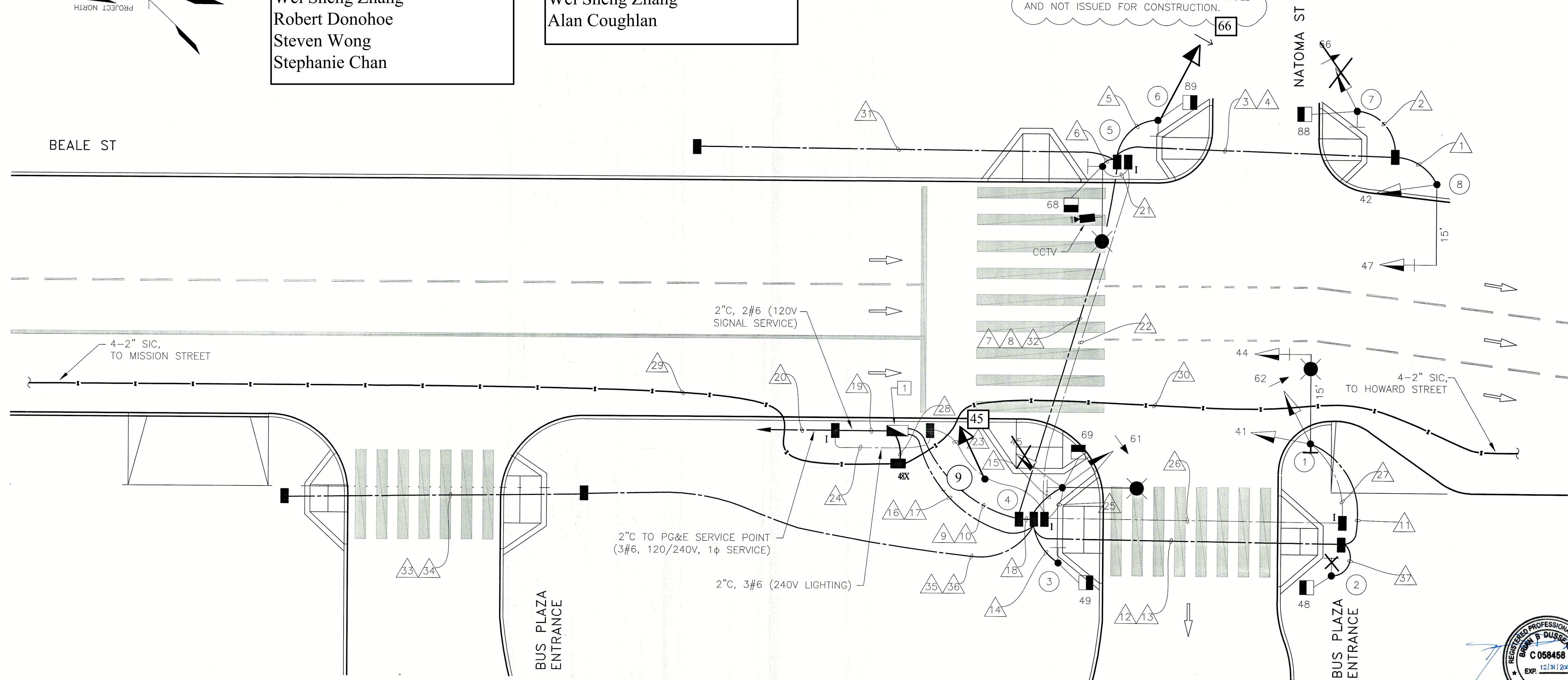

PROPOSED PHASE DIAGRAM

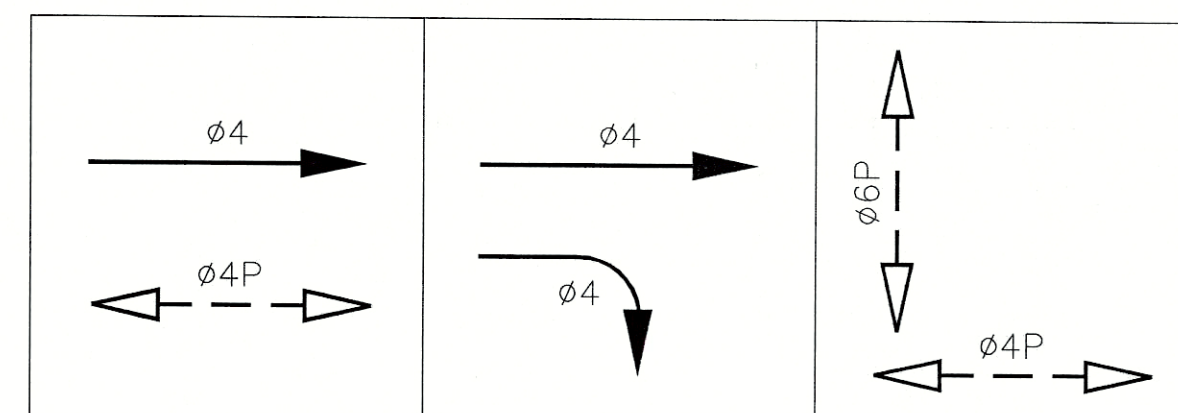

PER SRC 2019-274 REMOVE RIGHT  
ARROWS FOR SIGNALS #41, #44,  
#45. INSTALL CH1 TIMING CARD.  
6/11/2020. S. WONG

SHEET NOTES

- CONTRACTOR TO INSTALL TYPE 2070LXN2 CONTROLLER UNIT (PROCURED FROM CITY).
- CONTRACTOR TO INSTALL TYPE M-SF TALL CABINET AND ASSEMBLY (PROCURED FROM CITY) AND CONSTRUCT AN M-SF TALL CONTROLLER CABINET FOUNDATION AND ANCHOR BOLTS. DOOR TO OPEN AWAY FROM INTERSECTION.
- CONTRACTOR TO INSTALL BATTERY BACK-UP SYSTEM (AS SPECIFIED BY CITY), CAPABLE OF FITTING INSIDE THE CONTROLLER CABINET.

| NO. | DATE | DESCRIPTION | BY | APP |
|-----|------|-------------|----|-----|
|     |      |             |    |     |
|     |      |             |    |     |
|     |      |             |    |     |
|     |      |             |    |     |
|     |      |             |    |     |
|     |      |             |    |     |
|     |      |             |    |     |
|     |      |             |    |     |
|     |      |             |    |     |

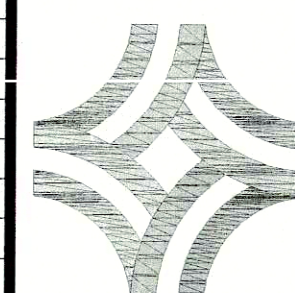

**SFMTA**  
Municipal Transportation Agency

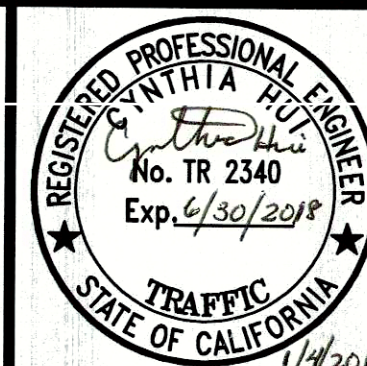

|                                    |              |
|------------------------------------|--------------|
| APPROVED                           | SCALE:       |
| <i>[Signature]</i> January 9, 2018 | AS SHOWN     |
| SENIOR ENGINEER                    | DATE:        |
| DRAWN: S WONG                      | DATE: 1/2018 |
| CHECKED: C HUI                     | DATE: 1/2018 |
| CITY TRAFFIC ENGINEER              | DATE:        |

|               |
|---------------|
| SHEET/SHEETS: |
|               |

|  |
|--|
| TRANSBAY TRANSIT CENTER PROGRAM                            |
| BEALE STREET AND BUS PLAZA ENTRANCE<br>TRAFFIC SIGNAL WORK |

|                       |
|-----------------------|
| CONTRACT NO.          |
| DRAWING NO.<br>ET-3.0 |
| FILE NO.              |
| REV. NO.<br>0         |

FILE NAME:  
DATE: --/--/--



| POLE AND EQUIPMENT SCHEDULE |   |                          |                     |   |                             |                   |        |          |  |
|-----------------------------|---|--------------------------|---------------------|---|-----------------------------|-------------------|--------|----------|--|
| LOCATION                    | TYPE OF POLE  | LUMEC<br>GPLM<br>WATTAGE | VEHICLE SIGNAL      |   |                             | PEDESTRIAN SIGNAL |        |          | REMARKS  |
|                             |   |                          | NO.                 | TYPE  | MOUNTING                    | NO.               | TYPE   | MOUNTING |  |
| ①                           | 17-2-100 WITH<br>15-FT MAST ARM<br>AND 6-FT LUMINAIRE ARM | 164W                     | 41<br>44<br>62      | <del>45-42" 3S12"</del><br><del>45-42" 3S12"</del><br>3S12"LA | SV-1-T<br>MAS<br>SV-1-T     |                   |        |          | VEHICLE SIGNAL 44 TO HAVE BACKPLATE. Wire APS Unit to Ped Signal 48.                       |
| ②                           | 1-A (10')   |                          |                     |   |                             | 48                | 1S-LED | SP-1     | <del>WIRE APS UNIT TO PED SIGNAL 48.</del>   |
| ③                           | 1-A (10')   |                          |                     |   |                             | 49                | 1S-LED | SP-1     | WIRE APS UNIT TO PED SIGNAL 49.  |
| ④                           | CITY<br>STANDARD<br>STREETLIGHT                           | 164W                     | <del>45</del><br>61 | <del>45-42" GRA</del><br>3S12"LA                              | <del>SV-1-T</del><br>SV-1-T | 69                | 1S-LED | SP-1     | WIRE APS UNIT TO PED SIGNAL 69.  |
| ⑤                           | MUNI POLE NO. 770<br>WITH 6-FT LUMINAIRE ARM              | 164W                     |                     |   |                             | 68                | 1S-LED | SP-1     | WIRE APS UNIT TO PED SIGNAL 68.<br>F/I CCTV; ATTACH TO POLE APPROXIMATELY 22' ABOVE GRADE. |
| ⑥                           | 1-A (10')   |                          | 66                  | 3S12"LA   | TV-1-T                      | 89                | 1S-LED | SP-1     | WIRE APS UNIT TO PED SIGNAL 89.  |
| ⑦                           | 1-A (10')   |                          | <del>66</del>       | <del>3S12"LA</del>  | <del>TV-1-T</del>           | <del>88</del>     | 1S-LED | SP-1     | WIRE APS UNIT TO PED SIGNAL 88.  |
| ⑧                           | 16-2-100 WITH<br>15-FT MAST ARM                           |                          | 42<br>47            | 3S12"<br>3S12"  | SV-1-T<br>MAS               |                   |        |          | VEHICLE SIGNAL 47 TO HAVE BACKPLATE.   |
| ⑨                           | 1-A (10')   |                          | 45                  | <del>45-42" GRA</del><br>3S12"                                | TV-1-T                      |                   |        |          |  |

NOTES

1. ALL PVC CONDUITS SHALL HAVE A 1#6 (BSCW) GROUND WIRE. F/I GROUND ROD AND GROUNDING LAYOUT AS SHOWN ON SPDPWSF #88,739.
2. SPLICING OF GROUND WIRE SHALL BE PER SPDPWSF #87,204.
3. SERVICE CONNECTIONS SHALL BE MADE PER SPDPWSF #87,203. IF THE PLAN REQUIRES FUSING IN A PULL BOX FOR IC SERVICE, THIS IS THE POINT THE NEUTRAL IS BONDED TO THE GROUND.
4. CONTRACTOR SHALL COORDINATE WITH PG&E VIA TJPA FOR SERVICE CONNECTION WORK PRIOR TO START OF CONSTRUCTION. LOCATION OF PG&E SERVICE POINT IS UNDETERMINED AND SUBJECT TO CHANGE.
5. ALL PULL BOXES SHOWN ARE CCSF/SFMTA TYPE III, UNLESS OTHERWISE INDICATED.

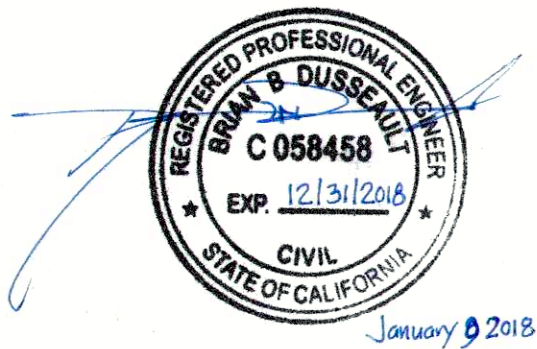

| NO.   | DATE | DESCRIPTION | BY | APP |
|---|------|-------------|----|-----|
|   |      |             |    |     |
|   |      |             |    |     |
|   |      |             |    |     |
|   |      |             |    |     |
| TABLE OF REVISIONS                                    |      |             |    |     |
| CHECK WITH TRACING TO SEE IF YOU HAVE LATEST REVISION |      |             |    |     |



**SFMTA**  
Municipal Transportation Agency



|          |  |        |  |
|----------|--|--------|--|
| DRAWN:   |  | DATE:  |  |
| S WONG   |  | 1/2018 |  |
| CHECKED: |  | DATE:  |  |
| C HUI    |  | 1/2018 |  |

|                       |       |
|-----------------------|-------|
| APPROVED              |       |
|                       |       |
| January 9 2018        |       |
| SENIOR ENGINEER       | DATE: |
|                       |       |
| CITY TRAFFIC ENGINEER | DATE: |

|               |
|---------------|
| SCALE:        |
| AS SHOWN      |
| SHEET/SHEETS: |

TRANSBAY TRANSIT CENTER PROGRAM

BEALE STREET AND BUS PLAZA ENTRANCE  
POLE AND EQUIPMENT SCHEDULE

|                       |
|-----------------------|
| CONTRACT NO.          |
| DRAWING NO.<br>ET-3.1 |
| FILE NO.              |
| REV. NO.<br>0         |

FILE NAME:  
DATE: --/--/--



