

SIGNAL SWITCHOVER 7/9/2019
DARK @ 9:07 AM, 3-COLOR @ 10:02 AM
J. HORNOSTEL (MTA), R. DIAZ (SFPW)
P. NGUYEN, M. TODD (SIGNAL SHOP)

APS NOT YET INSTALLED

POLE AND EQUIPMENT SCHEDULE										
POLE No.	TYPE OF POLE	LUMINAIRE VOLTAGE/WATTAGE	VEHICLE SIGNAL					PEDESTRIAN SIGNAL		
			No.	TYPE	MOUNTING	VISORS	LOUVERS	No.	TYPE	MOUNTING
①	MARBELITE STREETLIGHT		81	3S12"	SV-1-T	T		69 88	1S-COUNT 1S-COUNT	SP-1-SF(12") SP-1(22")
②	PPB POLE									APS-2W
③	PPB POLE									APS-2W
④	1-A (10')		22	3S12"	TV-1-T	T				
⑤	17-2-100 WITH 20' MA AND 6' LA	A2 145 6	21 24	3S12" 3S12"	SV-1-T MAS	T T		28	1S-COUNT	SP-1
⑥	1-A (12')		42	3S12"	TV-1-T	T		89	1S-COUNT	SP-1
⑦	MARBELITE STREETLIGHT		41 86	3S12" 3S12"	SV-2-TA	T T		48	1S-COUNT	SP-1
⑧	1-A (10')		62	3S12"	TV-1-T	T		29	1S-COUNT	SP-1
⑨	17-2-100 WITH 20' MA AND 6' LA	A2 145 6	61 64	3S12" 3S12"	SV-1-T MAS	T T		68	1S-COUNT	SP-1
⑩	PPB POLE									APS-2W
⑪	1-A (13')		82	3S12"	TV-1-T	T		49	1S-COUNT	SP-1

SHEET NOTES:

- ABANDON EXISTING CONDUIT AND WIRING, CUT EXISTING CONDUIT TO PULLBOX WALL AND CAP ENDS. PRIOR TO REMOVING OF EXISTING CABLES IN EXISTING CONDUIT, FIELD VERIFY AND MAINTAIN SERVICES TO STREETLIGHTS AND TRAFFIC CONTROLLER.
- INSTALL CITY FURNISHED ONE SECTION LED PEDESTRIAN COUNTDOWN SIGNAL MODULE IN CONTRACTOR FURNISHED ONE SECTION PEDESTRIAN SIGNAL HOUSING.
- CITY FORCES TO INSTALL CITY FURNISHED APS PUSH BUTTONS ON POLES AS SHOWN ON INTERSECTION DRAWING AND AS INDICATED IN POLE & EQUIPMENT SCHEDULE. CONTRACTOR TO F/I WIRING AS SHOWN IN THE CONDUIT AND WIRING SCHEDULE.
- CONTROLLER SERVICE POINT IS A PG&E SECONDARY BOX LOCATED 40' EAST OF THE NORTHEAST CORNER OF CALIFORNIA AND LAGUNA STREETS. COORDINATE WITH PG&E THROUGH SFPUC FOR ACTIVATION OF SERVICE POINT.
- F/I 40A INLINE FUSE AND FUSE HOLDER FOR TRAFFIC SIGNAL SERVICE DISCONNECT IN FIRST PULL BOX NEXT TO THE NEW PG&E SERVICE POINT.
- SEE LIGHTING FIXTURE SCHEDULE ON E-0.1
- MAINTAIN EXISTING CONDUIT, REMOVE EXISTING CABLES EXCEPT SERVICES TO STREETLIGHTS AND INTERCONNECT CABLES WHERE APPLICABLE. PRIOR TO REMOVAL OF EXISTING CABLES IN EXISTING CONDUIT, FIELD VERIFY AND MAINTAIN SERVICES TO STREETLIGHTS AND INTERCONNECT.
- EXTEND 12/C INTERCONNECT TO NEW IC LOCATION PER CONDUIT AND WIRING SCHEDULE. SPLICE TO EXISTING 12/C TO MAINTAIN INTERCONNECT SYSTEM.
- COORDINATE WITH USPS FOR RELOCATION OF MAIL BOX.
- ROUTE CONDUITS TO AVOID DISTURBING CONCRETE STREET. RESTORE ANY DAMAGED AREAS PER SFPW STANDARD SPECIFICATIONS.
- SPLICE NEW STREET LIGHT WIRES TO EXISTING STREETLIGHT SERVICE, PROVIDE 10A FUSE AND FUSE HOLDER, MAINTAIN EXISTING STREET LIGHT CIRCUIT.

PHASE DIAGRAM

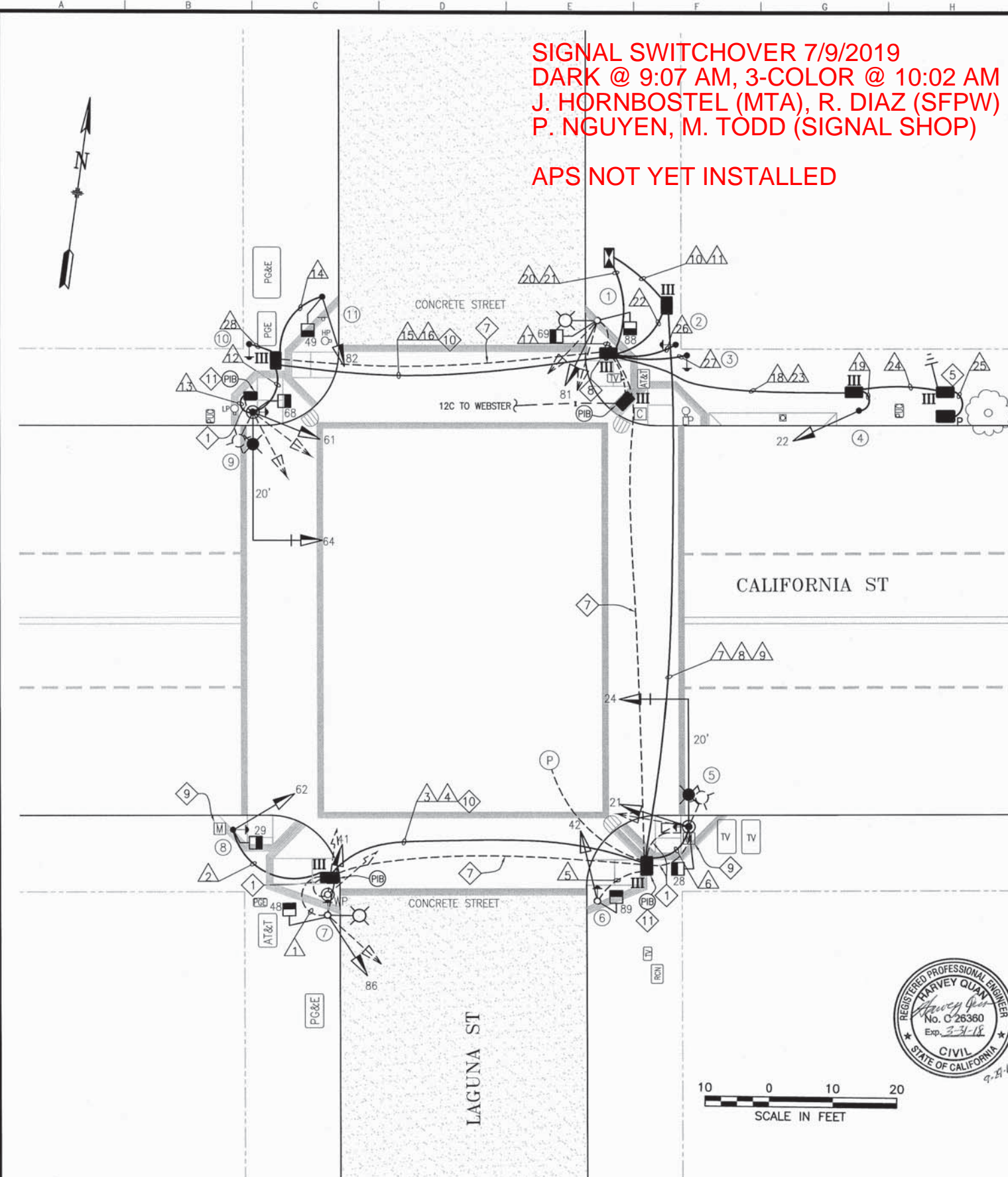
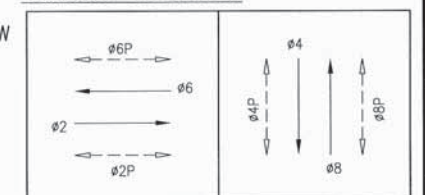

10 0 10 20
SCALE IN FEET

NO.	DATE	DESCRIPTION	BY	APP.
TABLE OF REVISIONS				

REFERENCE INFORMATION
& FILE NO. OF SURVEYS



DESIGN & ENGINEERING
CITY & COUNTY OF SAN FRANCISCO
SAN FRANCISCO PUBLIC WORKS
30 VAN NESS AVENUE, 5TH FLOOR
SAN FRANCISCO, CA 94102 - 6028

Section Mgr:	PHILIP THWIN	Date:	10/2/17
Deputy Division Mgr:	IQBALBHAI DHAPA	Date:	10/2/17
Division Mgr:	PATRICK RIVERA	Date:	10/2/17

DESIGNED:	DATE:
JH/CMF	5/2017
DRAWN:	DATE:
JH/CMF	5/2017
CHECKED:	DATE:
GD/SL	5/2017

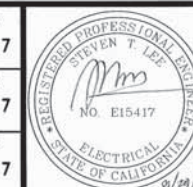

SCALE:	AS SHOWN
SHEET OF SHEETS	28 OF 63

CONTRACT 34 - TRAFFIC
SIGNAL MODIFICATIONS
CALIFORNIA STREET AND LAGUNA STREET
TRAFFIC SIGNAL WORK
POLE AND EQUIPMENT SCHEDULE

CONTRACT NO.	2805J
DRAWING NO.	E-10.0
FILE NO.	109,564
REV. NO.	

CONDUIT AND WIRING SCHEDULE (FURNISH AND INSTALL CONDUIT AND WIRES)																																		
CONDUIT RUN NUMBER	1	2	3	4	5	6	7	8	9	10	11	12	13	14	15	16	17	18	19	20	21	22	23	24	25	26	27	28						
CONDUIT SIZE (INCH)	UNK	2	2	2	UNK	2	2	2	2	3	2	2	2	2	2	2	2	2	2	3	2	2	2	2	3	1	1	1						
	EX			SP	EX	GRS				SP			GRS			SP						SP												
NOTES																																		
VEHICLE SIGNAL 41	3	3					3			3																								
VEHICLE SIGNAL 86	3	3					3			3																								
PED SIGNAL 48	2	2					2			2																								
APS XING LAGUNA ON POLE 7	2	2					2			2																								
VEHICLE SIGNAL 62		3	3				3			3																								
PED SIGNAL 29		2	2				2			2																								
APS XING CALIFORNIA ON POLE 8		2	2				2			2																								
VEHICLE SIGNAL 42						3		3		3																								
PED SIGNAL 89						2		2		2																								
APS XING LAGUNA ON POLE 6						2		2		2																								
VEHICLE SIGNAL 21							3	3		3																								
VEHICLE SIGNAL 24							3	3		3																								
PED SIGNAL 28							2	2		2																								
APS XING CALIFORNIA ON POLE 5							2	2		2																								
VEHICLE SIGNAL 61												3			3						3													
VEHICLE SIGNAL 64												3			3						3													
PED SIGNAL 68												2			2						2													
APS XING CALIFORNIA ON POLE 9												2			2						2													
VEHICLE SIGNAL 82														3	3						3													
PED SIGNAL 49														2	2						2													
APS XING LAGUNA ON POLE 10															2						2										2			
VEHICLE SIGNAL 81																	3				3													
PED SIGNAL 69																	2				2													
PED SIGNAL 88																	2				2													
APS XING LAGUNA ON POLE 3																					2										2			
APS XING CALIFORNIA ON POLE 2																					2													
VEHICLE SIGNAL 22																		3	3		3													
#14 NEUTRAL	2	2				2	3						3		2			3			1													
#14 SPARE			3				3			3							3					3												
TOTAL #14 WIRES	12	9	20		9	13	20	17		37		13		7	20		10	3	4	34						2	2	2						
#10 WIRES NEUTRAL			1				1	1		2							1				2													
#10 WIRES STREET LIGHT	(2)					2							2				(2)																	
#8 WIRES STREET LIGHT																																		
#8 WIRES (120 V SERVICE)																					2		2	2	3									
#6 BSCW																																		
INTERCONNECT 12C CABLE																																		

SHEET NOTES:

- 1 F/I PER GROUNDING LAYOUT DETAIL AND PROJECT SPECIFICATIONS SECTION 34 41 13.
- 2 (#) INDICATES EXISTING WIRE TO REMAIN

