

FLASHING OPERATIONS ACTIVATED ON 12/7/10 @ 12:30 PM
ATTENDED BY: GERARDINE TE LENCATE,
WEI ZHANG (SIGNAL SHOP), UIM TA PASIO (SIGNAL
SHOP), AND BEN WU (PPW)
ACTIVATED TO 3-COLOR ON 12/9/10 AT 12:49 PM

POLE AND EQUIPMENT SCHEDULE

POLE No.	TYPE OF POLE	VEHICLE SIGNAL				PEDESTRIAN SIGNAL			REMARKS
		No.	TYPE	MOUNTING	VISORS	No.	TYPE	MOUNTING	
①	18-2-100 W/25' MAST ARM	21 66 24	3S12" 3S12" 3S12"	SV-2-TA MAS	T T T	28	1S-COUNT	SP-1	BACKPLATE
②	PPB POLE (CALTRANS STANDARD)								APS PPB (TO BE F/I BY CITY FORCES)
③	EX. SL					29 48	1S-COUNT 1S-COUNT	SP-1-SF (12") SP-1 (22")	APS PPB (TO BE F/I BY CITY FORCES)
④	PPB POLE (CALTRANS STANDARD)								APS PPB (TO BE F/I BY CITY FORCES)
⑤	18-2-100 W/25' MAST ARM	64	3S12"	MAS	T				BACKPLATE
⑥	CITY STANDARD STREET LIGHT	26 61 82	3S12" 3S12" 3S12"	SV-3-TA	T T T	49	1S-COUNT	SP-1	APS PPB (TO BE F/I BY CITY FORCES)
⑦	1-A (10')	81	3S12"	TV-1-T	T				

SHEET NOTES:

- COORDINATE WITH TRAFFIC ENGINEER TO SCHEDULE R/C EXISTING TRAFFIC ISLAND AND REPAVEMENT OF ROADWAY FLUSH WITH SURROUNDING STREET AREA. EXISTING CROSSWALK CROSSING CLARENDON AT PANORAMA MAY BE CLOSED WHILE TRAFFIC ISLAND IS DEMOLISHED AND PEDESTRIANS REDIRECTED TO CROSS THE NORTH LEG OF THE INTERSECTION. CONTRACTOR SHALL PROVIDE FLAG PERSONS TO DIRECT VEHICULAR AND PEDESTRIAN TRAFFIC AS RECOMMENDED BY THE TRAFFIC ENGINEER. THE TRAFFIC ISLAND DEMOLITION WORK SHALL BE SCHEDULED AS CLOSE AS POSSIBLE TO THE SIGNAL ACTIVATION DATE TO MINIMIZE THE TIME THAT THE CROSSWALK IS CLOSED AND TO MINIMIZE DISRUPTION TO CLARENDON ELEMENTARY SCHOOL.
- EXISTING CROSSWALK CROSSING CLARENDON AND SOME EXISTING LANE STRIPING ON CLARENDON TO BE DELETED BY CITY FORCES IMMEDIATELY BEFORE SIGNALS ARE TO BE ACTIVATED.
- NEW CROSSWALK CROSSING CLARENDON AND NEW LANE STRIPING ON CLARENDON TO BE INSTALLED BY CITY FORCES IMMEDIATELY BEFORE SIGNALS ARE TO BE ACTIVATED.
- EXISTING STOP MESSAGE TO BE REMOVED BY CITY FORCES BEFORE SIGNAL ACTIVATION.
- EXISTING CROSSWALK CROSSING PANORAMA TO BE WIDENED BY APPROXIMATELY 3 FEET BY CITY FORCES.
- CONTRACTOR SHALL AVOID DAMAGE TO EXISTING CURB RAMPS. CONTRACTOR SHALL REPLACE RAMP(S) IN KIND IF DAMAGED.
- CONTRACTOR TO INSTALL CITY FURNISHED INTERSECTION SIGNAL CONTROLLER CABINET.
- CITY FORCES TO INSTALL CITY FURNISHED WIRELESS SENSORS AND ASSOCIATED EQUIPMENT INCLUDING ACCESS POINT, CAT 5 CABLE, AND CONTACT CLOSURE INTERFACE CARD.
- CITY FORCES TO INSTALL CITY FURNISHED APS BUTTONS ON POLES AS SHOWN ON INTERSECTION DRAWING AND AS INDICATED IN POLE & EQUIPMENT SCHEDULE.

DETAIL NOTES:

- ③ SPLICE NEW STREET LIGHT WIRING TO LINE SIDE OF SERVICE WIRING. F/I FUSE AND FUSE HOLDER PER SPDPWSF FILE 87,203.
- ⑤ CONTRACTOR SHALL COORDINATE WITH PG&E VIA FRANK SYLVESTER OF SFPUC POWER ENTERPRISE AT (415) 554-1578 FOR SERVICE CONNECTION WORK PRIOR TO START OF CONSTRUCTION.
- ⑦ F/I IN-LINE FUSE HOLDER W/ 40 A FUSE FOR IC SERVICE.
- ⑦ CONTRACTOR SHALL F/I A LABEL ON THE PG&E SERVICE CABLES IN THE IC CABINET THAT IDENTIFIES CORNER OF INTERSECTION WHERE IN-LINE FUSE HOLDER FOR IC SERVICE WAS INSTALLED. (I.E. A SAMPLE LABEL IS AS FOLLOWS: "IC IN-LINE FUSE HOLDER INSTALLED IN NE CORNER")

NOTE:
THIS AUTOCAD DRAWING HAS BEEN REVISED AND REPLOTED SUBSEQUENT TO INTERNAL ENGINEERING APPROVAL AND SIGN-OFF. FOR THOSE SIGNATURES, SEE THE DRAWING PLOTTED AND ISSUED PREVIOUSLY DURING BIDDING. THE SIGNED DRAWING REMAINS VALID EXCEPT FOR THE CHANGES ONLY AS CLEARLY MARKED ON THIS DRAWING AND ISSUED UNDER THIS LATEST REVISION NUMBER AS SHOWN IN THE TABLE OF REVISIONS LOCATED AT THE LOWER LEFT CORNER OF THE DRAWING. ALL ISSUED REVISIONS SUBSEQUENT TO PREVIOUSLY PLOTTED DRAWING DURING BIDDING REMAIN VALID UNLESS SUPERSEDED BY LATER ISSUED REVISIONS. CHECK ALL ISSUED REVISIONS OF THIS DRAWING.

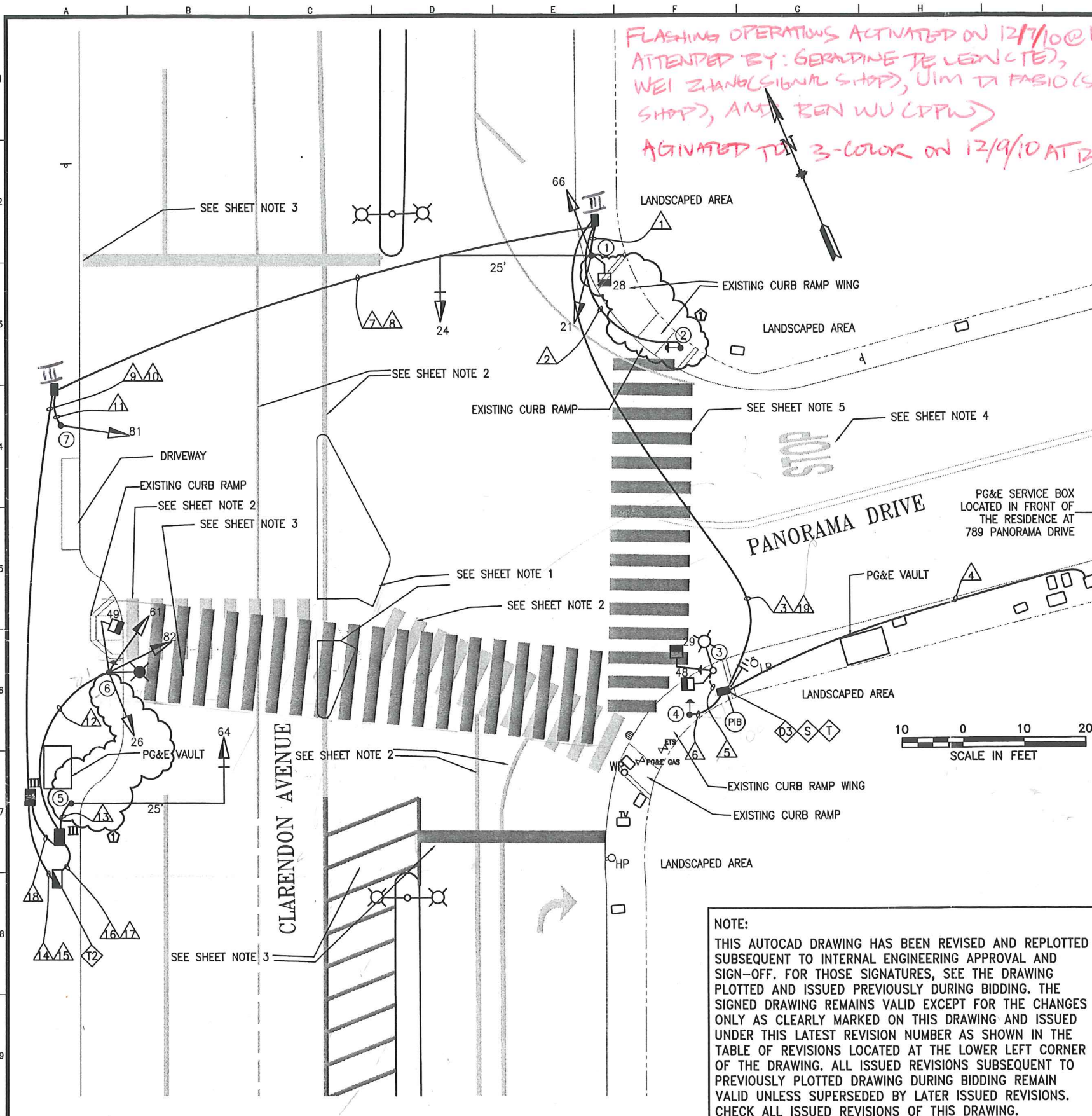
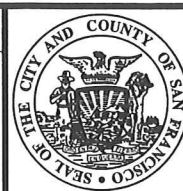

TABLE OF REVISIONS			
NO.	DATE	DESCRIPTION	BY APP.
①	9/04	PCO-1: VARIOUS CHANGES ON POLE LAYOUT	JS SL

CHECK WITH TRACING TO SEE IF YOU HAVE LATEST REVISION

REFERENCE INFORMATION
& FILE NO. OF SURVEYS



BUREAU OF ENGINEERING
DEPARTMENT OF PUBLIC WORKS
CITY AND COUNTY OF SAN FRANCISCO



DESIGNED:	DATE:	APPROVED
GD	3/2010	
DRAWN:	DATE:	SECTION MANAGER DATE:
GD	3/2010	
CHECKED:	DATE:	DEPUTY BUREAU MANAGER DATE:
BBD	3/2010	
		CITY ENGINEER DATE:

SCALE:
AS SHOWN
SHEET OF SHEETS
9 OF 10

CLARENDON AV & PANORAMA DR
NEW TRAFFIC SIGNALS

TRAFFIC SIGNAL WORK

SPECIFICATION NO.
1734J
DRAWING NO.
E-1.0
FILE NO.
91,000
REV. NO.
1

CONDUIT AND WIRING SCHEDULE																			
CONDUIT RUN NUMBER	1	2	3	4	5	6	7	8	9	10	11	12	13	14	15	16	17	18	19
CONDUIT SIZE (INCH)	2	1	2	2	EX	1	2	2	2	2	2	2	2	3	2	3	2	2	2
NOTES																	SP		
F/ #14 WIRES	VEHICLE SIGNAL 24	3					3		3					3					
	VEHICLE SIGNAL 21	3					3		3					3					
	VEHICLE SIGNAL 66	3					3		3					3					
	PED SIGNAL 28	2					2		2					2					
	APS PPB FOR XING PANORAMA ON POLE 2		2				2		2					2					
	PED SIGNAL 48			2		2	2		2					2					
	PED SIGNAL 29			2		2	2		2					2					
	APS PPB FOR XING PANORAMA ON POLE 3			2		2	2		2					2					
	APS PPB FOR XING CLARENDON ON POLE 4			2		2	2		2					2					
	VEHICLE SIGNAL 81								3		3			3					
F/ WIRES AS NOTED	VEHICLE SIGNAL 61											3				3			
	VEHICLE SIGNAL 82											3				3			
	PED SIGNAL 49											2				2			
	APS PPB FOR XING CLARENDON ON POLE 6											2				2			
	VEHICLE SIGNAL 26											3				3			
	VEHICLE SIGNAL 64											3				3			
	#14 NEUTRAL	3	1			2					1	2	1						
	#14 SPARE			3				3		3									
	TOTAL #14 WIRES	14	3	11		8	2	24		27		4	15	4	24		19		
	#10 WIRES NEUTRAL			1				2		3				3		1			
INSTALL WIRES AS NOTED	#10 WIRES STREET LIGHT											2							
	#8 WIRES (120V SERVICE)				2				2		2				2			2	
	#8 WIRES STREET LIGHT								2		2						2	2	
	1/4" NYLON PULL ROPE															1			
	INSTALL CITY FURNISHED BELDEN 8489 (OR EQUIVALENT) FOR LOCATIONS BELOW (SEE SHEET NOTE 2):																		
	APS PPB XING PANORAMA ON POLE 2 (PULL TO APS CONTROL UNIT IN PED SIGNAL 28 ON POLE 1)	1	1																
	APS PPB XING PANORAMA ON POLE 3 (PULL TO APS CONTROL UNIT IN PED SIGNAL 29 ON POLE 3)																		
	APS PPB XING CLARENDON ON POLE 4 (PULL TO APS CONTROL UNIT IN PED SIGNAL 48 ON POLE 3)					1	1												
	APS PPB XING CLARENDON ON POLE 6 (PULL TO APS CONTROL UNIT IN PED SIGNAL 49 ON POLE 6)																		

SHEET NOTE:

1. SEE GROUNDING LAYOUT  AND SECTION 02890 IN CONTRACT SPECIFICATIONS
2. CONTRACTOR TO INSTALL CITY FURNISHED BELDEN CABLE 8489 (OR EQUIVALENT) AS INDICATED IN CONDUIT AND WIRING SCHEDULE. THIS SHALL BE CONSIDERED INCIDENTAL WORK TO BID ITEM 26.

PHASE DIAGRAM

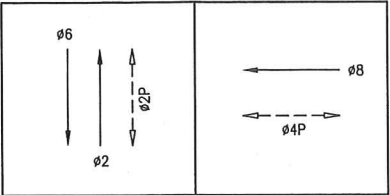

PHASE SEQUENCE

G	Y	R	CLARENDON AVE. (NB&SB) - $\phi 2$ & $\phi 6$
R	G	Y	R
WM	FRH	RH	PANORAMA DR. (WB) - $\phi 8$
RH	WM	FRH	RH
			PED XING PANORAMA DR. (E/S) - $\phi 2P$
			PED XING CLARENDON AVE. (S/S) - $\phi 4P$

NOTE:
THIS AUTOCAD DRAWING HAS BEEN REVISED AND REPLOTTED SUBSEQUENT TO INTERNAL ENGINEERING APPROVAL AND SIGN-OFF. FOR THOSE SIGNATURES, SEE THE DRAWING PLOTTED AND ISSUED PREVIOUSLY DURING BIDDING. THE SIGNED DRAWING REMAINS VALID EXCEPT FOR THE CHANGES ONLY AS CLEARLY MARKED ON THIS DRAWING AND ISSUED UNDER THIS LATEST REVISION NUMBER AS SHOWN IN THE TABLE OF REVISIONS LOCATED AT THE LOWER LEFT CORNER OF THE DRAWING. ALL ISSUED REVISIONS SUBSEQUENT TO PREVIOUSLY PLOTTED DRAWING DURING BIDDING REMAIN VALID UNLESS SUPERSEDED BY LATER ISSUED REVISIONS. CHECK ALL ISSUED REVISIONS OF THIS DRAWING.

NO.	DATE	DESCRIPTION	BY	APP.
1	9/04	PCO-1: VARIOUS CHANGES ON POLE LAYOUT	JS	SL
CHECK WITH TRACING TO SEE IF YOU HAVE LATEST REVISION				

REFERENCE INFORMATION
& FILE NO. OF SURVEYS



BUREAU OF ENGINEERING
DEPARTMENT OF PUBLIC WORKS
CITY AND COUNTY OF SAN FRANCISCO



DESIGNED: DATE: 3/2010
DRAWN: DATE: 3/2010
CHECKED: DATE: 3/2010
BDD

APPROVED
SECTION MANAGER DATE:
DEPUTY BUREAU MANAGER DATE:
CITY ENGINEER DATE:

SCALE:
NO SCALE
SHEET OF SHEETS
10 OF 10

CLARENDON AV & PANORAMA DR
NEW TRAFFIC SIGNALS
CONDUIT AND WIRING SCHEDULE

SPECIFICATION NO. 1734J
DRAWING NO. E-1.1
FILE NO. 91,001
REV. NO. 1