

4/30/21 Traffic Signal Switchover  
8:58am Dark, 9:05am Emergency Flash, 9:18am 3-color. APS  
not installed yet. Transit Signal 131 & 133 disabled.

Staff  
Ken Kwong (TE), Phong Nguyen (Signal Shop), Dennis Verhalen  
(Signal Shop), Cameron Peters (Phoenix), Wilson Lew (Phoenix)

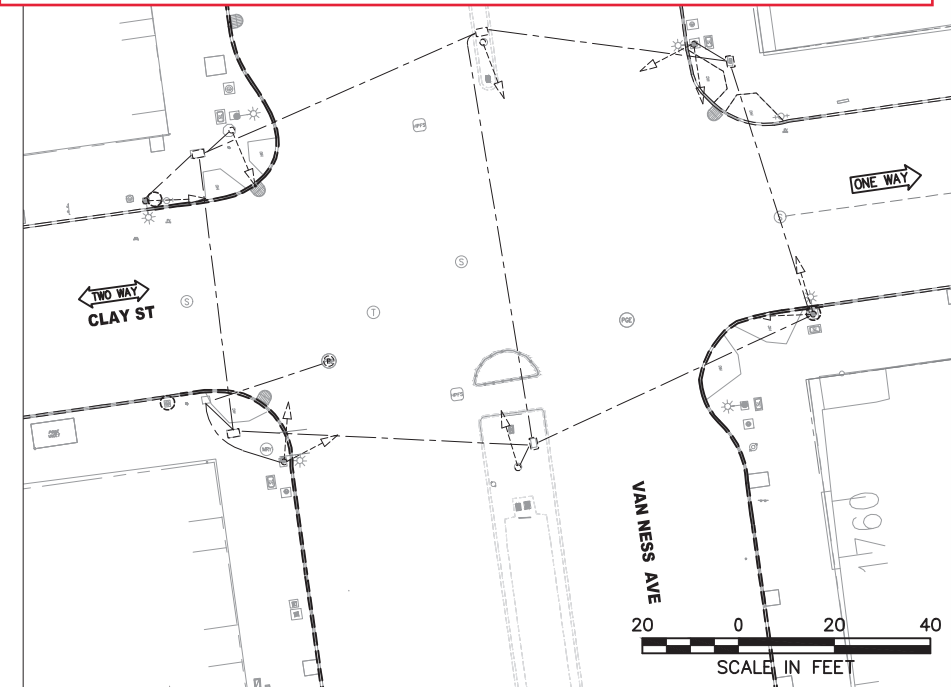

EXISTING EQUIPMENT

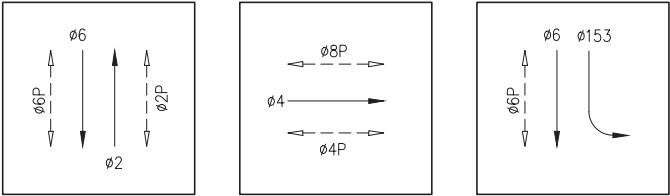

PHASE DIAGRAM

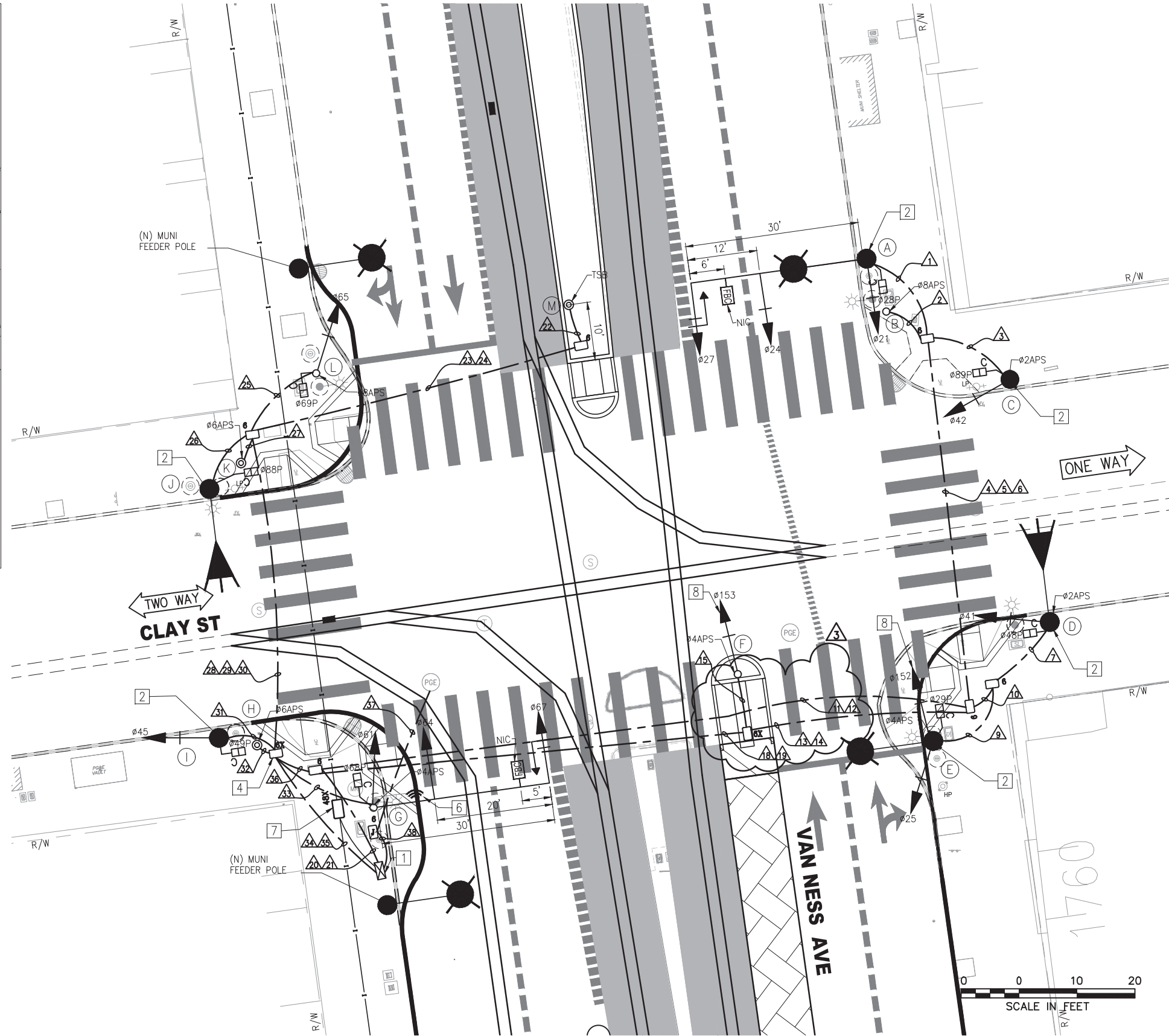

FOR ORIGINAL SIGNATURES, SEE ET-119.0, REV 0

3	11/10/20	CONFORMED SET: UPDATED W/RFI #932	KK	MV	CL
2	7/18/19	LATEST DRAWING	KK	MV	CL
1	03/2018	CHANGED DISTANCE BETWEEN SIGNALS 24 AND 27 FROM 10' TO 12', CHANGED DISTANCE BETWEEN SIGNALS 64 AND 67 FROM 8' TO 20'; ADDED FBC SIGNS ON POLES A AND H, UPDATED POLE A MA LENGTH, UPDATED APS ON POLE B,C, AND D; ADDED TYPE 6X PULLBOXES	KK	MV	CL
NO.	DATE	DESCRIPTION	REVISED	CHECKED	APPROVED
REVISIONS					

DESIGNED	K. KWONG
DRAWN	K. KWONG
CHECKED	R. ZAMORA/C. LIU
REVIEWED	C. LIU
RECOMMENDED	P. WILSON
APPROVED	R. OLEA
DATE	12/4/2015



CITY AND COUNTY OF SAN FRANCISCO  
MUNICIPAL TRANSPORTATION AGENCY

APPROVED

for the DIRECTOR OF TRANSPORTATION

MUNI BUS RAPID TRANSIT SYSTEM  
VAN NESS CORRIDOR TRANSIT IMPROVEMENT PROJECT

CLAY STREET  
TRAFFIC SIGNAL WORK

1289

REVISION

ET-119.0

ET-204

3

F:\T.E. FILES\Sp\o\Projects\Van Ness BR\Signal Design\CADD\ CPTB401ETBS - 100% Rev. 3-3-21.dwg KKWONG Tue Mar 09,2021 - 12:16 pm

POLE AND EQUIPMENT SCHEDULE													
POLE NO.	POLE STANDARD			VEHICLE SIGNAL					PEDESTRIAN SIGNAL			HPS LUMINAIRE (WATTS)	SPECIAL REQUIREMENTS
	TYPE	SIG. MA (FEET)	OCS SL	No.	TYPE	MOUNTING	VISORS	LOUVERS	No.	TYPE	MOUNTING		
(A)	SIGNAL, SL & OCS COMBO POLE	30	1804 182	21 24 27	3S12" 3S12" 3S12"GUA	SV-1-T MAS MAS	T T T		28	1S-COUNT	SP-1	-	STRAIGHT HORIZONTAL SIGNAL MA MOUNT AT 21' HIGH SEE ST PLANS FOR POLE DETAILS TENON FOR FUTURE FBC MIDWAY BETWEEN MAS SIGNALS
(B)	PPBP POLE	-		-	-	-	-		-	-	-	-	APS 1
(C)	SIGNAL & OCS COMBO POLE	-	1796	42	3S12"	SV-1-T	T		89	1S-COUNT	SP-1	-	APS 1
(D)	SIGNAL, SL & OCS COMBO POLE	-	1799 177	41	3S12"	SV-1-T	T		48	1S-COUNT	SP-1	-	APS 1
(E)	SIGNAL, SL & OCS COMBO POLE	-	1792 178	25 152	3S12" 3S12"LB	SV-2-TA	T T		29	1S-COUNT	SP-1	-	APS 1
(F)	1-A (10')	-		153	3S12"LB	TV-1-T	T		-	-	-	-	APS 1
(G)	SPECIAL MAST ARM POLE (18-4-100)	30		61 64 67	3S12" 3S12" 3S12"GUA	SV-1-T MAS MAS	T T T		68	1S-COUNT	SP-1	-	STRAIGHT HORIZONTAL SIGNAL MA MOUNT AT 23.5' HIGH APS 1 TSP 2 TENON FOR FUTURE FBC 5' FROM END OF MAST ARM
(H)	PPBP POLE	-		-	-	-	-		-	-	-	-	APS 1
(I)	SIGNAL & OCS COMBO POLE	-	1809	45	3S12"	SV-1-T	T		49	1S-COUNT	SP-1	-	
(J)	SIGNAL, SL & OCS COMBO POLE	-	1808 182	-	-	-	-		88	1S-COUNT	SP-1	-	
(K)	PPBP POLE	-		-	-	-	-		-	-	-	-	APS 1
(L)	1-A (10')	-		65	3S12"	TV-1-T	T		69	1S-COUNT	SP-1	-	APS 1
(M)	TSB POLE	-		-	-	-	-		-	-	-	-	TSB

MOUNT SIGNAL 27 BETWEEN YELLOW AND GREEN 3

MOUNT SIGNAL 67 BETWEEN YELLOW AND GREEN 3

\*OTHER REQUIREMENTS ARE COVERED BY NOTES, LEGEND, SPECIAL PROVISIONS, AND STANDARD SPECIFICATIONS.  
FOR TYPE OF STANDARD, VEHICLE AND PEDESTRIAN SIGNAL MOUNTING, SEE CALTRANS STANDARD PLANS OR DETAIL DRAWINGS.

- 1 INSTALL APS WIRING AS SHOWN IN CONDUIT AND WIRING SCHEDULE. CITY FORCES TO INSTALL CITY FURNISHED APS UNIT.
- 2 INSTALL CITY FURNISHED TSP WIRING FROM TS OR COMBINED POLES WITH 3 FEET OF SLACK TO TS CABINET.
- 3 INSTALL CITY FURNISHED TRAFFIC CAMERA AND CONTRACTOR FURNISHED WIRING.
- 4 FOR STREETLIGHT WORK, SEE SL-SERIES PLANS.

FOR ORIGINAL SIGNATURES, SEE ET-119.1, REV 0

3	11/10/20	CONFORMED SET: UPDATED W/RFI #998	KK	MV	CL
2	7/18/19	LATEST DRAWING	KK	MV	CL
1	03/2018	UPDATED POLE NO., POLE STANDARD AND SPECIAL REQUIREMENT;UPDATED POLES A AND G, UPDATED APS ON POLE B, C, AND D; ADDED FBC TENON NOTE	KK	MV	CL
NO.	DATE	DESCRIPTION	REVISED	CHECKED	APPROVED
REVISIONS					

DESIGNED	K. KWONG
DRAWN	K. KWONG
CHECKED	R. ZAMORA/C. LUU
REVIEWED	C. LUU
RECOMMENDED	P. WILSON
APPROVED	R. OLEA
DATE	12/4/2015



CITY AND COUNTY OF SAN FRANCISCO  
MUNICIPAL TRANSPORTATION AGENCY

APPROVED

for the DIRECTOR OF TRANSPORTATION

MUNI BUS RAPID TRANSIT SYSTEM  
VAN NESS CORRIDOR TRANSIT IMPROVEMENT PROJECT

1289

CLAY STREET  
CONDUCTOR POLE AND EQUIPMENT SCHEDULES

ET-119.1

ET-204

REVISION

3

3

[illegible]

for the DIRECTOR OF TRANSPORTATION

3

BORDER REVISED 11/17/05