

Switchover - 12/6/2017
Dark: 9:00 AM 3-Color: 10:59 AM
Dark: 11:09 AM 3-Color: 11:11 AM
Mike Chue, Richard Ho, Robert Donohue (Signal Shop)
Jim Lau (BAL)
Denny Phan, Karl Johnson (PW)
Nikki Kobayashi (MTA)

Signal #44 not installed at tim eof switchover on 12/6/2017

Mast Arm Signal #44 Switchover - 7/26/2018
Steve Vannuchi (Signal Shop)
Jim Lau (BAL)
Nikki Kobayashi (MTA)

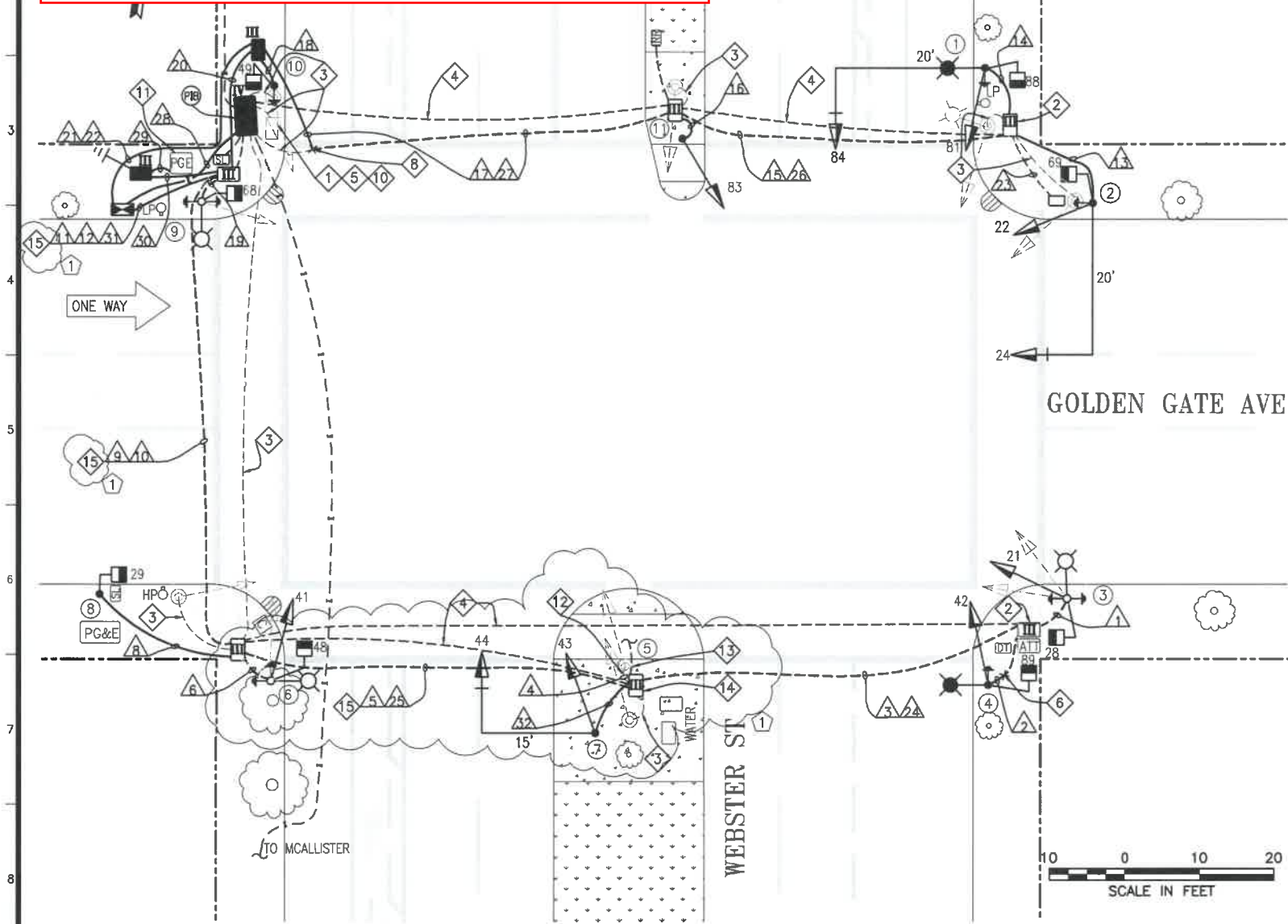

PHASE DIAGRAM

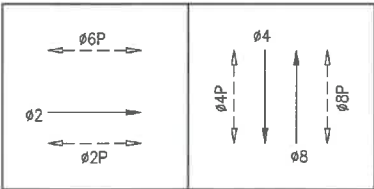

PHASE SEQUENCE

G	Y	R	GOLDEN GATE AVE EB (#2)		
R		G	Y	R	WEBSTER ST SB & NB (#4 & #8)
WM	FRH			RH	PEDS XING WEBSTER ST SS & NS (#2P & #6P)
	RH	WM	FRH	RH	PEDS XING GOLDEN GATE AVE WS & ES (#4P & #8P)

POLE AND EQUIPMENT SCHEDULE											
POLE No.	TYPE OF POLE	LUMINAIRE VOLTAGE/WATTAGE	VEHICLE SIGNAL					PEDESTRIAN SIGNAL			REMARKS
			No.	TYPE	MOUNTING	VISORS	LOUVERS	No.	TYPE	MOUNTING	
①	17-2-100 WITH 20' MA AND 6' LA	LED 73W	81 84	3S12" 3S12"	SV-1-T MAS	T T		88	1S-COUNT	SP-1	APS-2W BACKPLATE
②	16-2-100 WITH 20' MA		22 24	3S12" 3S12"	SV-1-T MAS	T T		69	1S-COUNT	SP-1	APS-2W BACKPLATE
③	EX. MARBELITE STREET LIGHT		21	3S12"	SV-1-T	T		28	1S-COUNT	SP-1	APS-2W PPB
④	MARBELITE STREET LIGHT	LED 73W	42	3S12"	SV-1-T	T		89	1S-COUNT	SP-1	APS-2W
⑤	NOT USED										
⑥	EX. MARBELITE STREET LIGHT		41	3S12"	SV-1-T	T		48	1S-COUNT	SP-1	APS-2W APS-2W
⑦	16-2-100 WITH 15' MA		43 44	3S12" 3S12"	SV-1-T MAS	T T					BACKPLATE
⑧	1-A (7')							29	1S-COUNT	TP-1	
⑨	EX. MARBELITE STREET LIGHT							68	1S-COUNT	SP-1	APS-2W PPB
⑩	1-A (7')							49	1S-COUNT	TP-1	APS-2W
⑪	1-A (10')		83	3S12"	TV-1-T	T					

SHEET NOTES:

- PULL BACK 12C CABLE TO NEAREST PULLBOX, SPLICE EXISTING 12C AND EXTEND TO NEW IC PER CONDUIT AND WIRING SCHEDULE
- SPLICE NEW STREET LIGHT WIRING TO EXISTING STREET LIGHT WIRING TO MAINTAIN STREET LIGHT CIRCUIT
- ABANDON (E) CONDUIT AND WIRING. CUT (E) CONDUIT AND WIRING TO PULLBOX WALL AND CAP ENDS. PRIOR TO ABANDONING OF (E) CABLES IN (E) CONDUIT, FIELD VERIFY AND MAINTAIN INTERCONNECT, AS WELL AS SERVICES TO STREETLIGHTS AND TRAFFIC CONTROLLER
- REMOVE (E) TRAFFIC SIGNAL CABLES EXCEPT SERVICE TO STREETLIGHTS AND INTERCONNECT CABLES WHERE APPLICABLE. PRIOR TO REMOVAL OF (E) CABLES IN (E) CONDUIT, FIELD VERIFY AND MAINTAIN (E) SERVICES TO STREETLIGHTS AND INTERCONNECT
- PULL BACK IRRIGATION WIRES TO NEAREST PULLBOX
- INTERCEPT (E) 2" PVC CONDUIT AND BRING INTO NEW STREET LIGHT POLE
- CONTRACTOR TO PROVIDE WIRING, CITY FORCES TO PROVIDE APS & PPB BUTTONS ON POLES AS SHOWN
- INTERCEPT (E) 2-2" PVC CONDUITS AND BRING INTO (N) TYPE 3 PULL BOX
- INSTALL CITY FURNISHED ONE SECTION LED PEDESTRIAN COUNTDOWN SIGNAL MODULE IN CONTRACTOR FURNISHED ONE SECTION PEDESTRIAN SIGNAL HOUSING
- COORDINATE WITH PG&E THROUGH SFPUC FOR DEACTIVATION OF SERVICE CONNECTION WORK TO BE COMPLETED AFTER ACTIVATION OF NEW SERVICE POINT. TEN WORKING DAYS NOTICE IS REQUIRED
- CONTROLLER SERVICE POINT IS A PG&E SECONDARY BOX LOCATED AT THE NORTHWEST CORNER OF THIS INTERSECTION. COORDINATE WITH PG&E THROUGH SFPUC FOR ACTIVATION OF SERVICE POINT
- ABANDON EXISTING CONDUIT. CUT EXISTING CONDUIT TO PULLBOX WALL AND CAP ENDS.
- R/S EXISTING 1-A POLE AND RELOCATE INSTALLED VEHICLE SIGNAL 43 TO NEW MAST ARM POLE 7
- SPLICE NEW #14 NEUTRAL WIRES WITH #10 NEUTRAL WIRE
- CONTRACTOR TO PROVIDE NEW WIRES AND HAVE THE OPTION TO RE-USE EXISTING WIRE IF THERE IS ENOUGH SLACK. UNUSED EXISTING WIRES SHOULD BE LABELED AS "SPARE"

NOTE:
THIS AUTOCAD DRAWING HAS BEEN REVISED AND REPLOTTED SUBSEQUENT TO INTERNAL ENGINEERING APPROVAL AND SIGN-OFF. FOR THOSE SIGNATURES, SEE THE DRAWING PLOTTED AND ISSUED PREVIOUSLY DURING BIDDING. THE SIGNED DRAWING REMAINS VALID EXCEPT FOR THE CHANGES ONLY AS CLEARLY MARKED ON THIS DRAWING AND ISSUED UNDER THIS LATEST REVISION NUMBER AS SHOWN IN THE TABLE OF REVISIONS LOCATED AT THE LOWER LEFT CORNER OF THE DRAWING. ALL ISSUED REVISIONS SUBSEQUENT TO PREVIOUSLY PLOTTED DRAWING DURING BIDDING REMAIN VALID UNLESS SUPERSEDED BY LATER ISSUED REVISIONS. CHECK ALL ISSUED REVISIONS OF THIS DRAWING.

NO.	DATE	DESCRIPTION	CMF BY	SL APP.
1	06/2017	POD 5 - POLE #7 MOVED TO MEDIAN	CMF	SL
TABLE OF REVISIONS				

REFERENCE INFORMATION
& FILE NO. OF SURVEYS



DESIGN & ENGINEERING
CITY & COUNTY OF SAN FRANCISCO
SAN FRANCISCO PUBLIC WORKS
30 VAN NESS AVENUE, 5TH FLOOR
SAN FRANCISCO, CA 94102 - 8028

Section Mgr:	PHILIP THWIN	Date:	
Deputy Division Mgr:	IQBALBHAI DHAPA	Date:	
Division Mgr:	PATRICK RIVERA	Date:	

DESIGNED:	DATE:
DY/NL	10/2016
DRAWN:	DATE:
DY/NL	10/2016
CHECKED:	DATE:
GD/SL	10/2016



SCALE:	AS SHOWN
SHEET OF SHEETS	12 OF 23

WEBSTER STREET
PEDESTRIAN COUNTDOWN SIGNAL UPGRADE

GOLDEN GATE AVENUE AND WEBSTER STREET
TRAFFIC SIGNAL WORK

CONTRACT NO.	2785J
DRAWING NO.	E-2.0
FILE NO.	106,876
REV. NO.	1

