

STATE OF CALIFORNIA - DEPARTMENT OF TRANSPORTATION
Caltrans® ELECTRICAL DESIGN
FUNCTIONAL SUPERVISOR
KENNETH XU
CALCULATED-DESIGNED BY
CHECKED BY
MICHELLE CHAN
KENNETH XU
REVISED BY
DATE REVISED
MC
6-14-18

NOTE:
FOR ACCURATE RIGHT OF WAY DATA, CONTACT
RIGHT OF WAY ENGINEERING AT THE DISTRICT OFFICE.

5

Dist	COUNTY	ROUTE	POST MILES TOTAL PROJECT	SHEET NO.	TOTAL SHEETS
04	SF	1	R0.0/6.9	119	180
Kenneth Y. Xu 6-14-18 REGISTERED ELECTRICAL ENGINEER DATE					
6-29-18 PLANS APPROVAL DATE					
THE STATE OF CALIFORNIA OR ITS OFFICERS OR AGENTS SHALL NOT BE RESPONSIBLE FOR THE ACCURACY OR COMPLETENESS OF SCANNED COPIES OF THIS PLAN SHEET.					

Signal Switchover 10/21/2020 at 12:15 pm
SSD Engineer: Kevin Shue
Signal Shop Electrician: Marcus Todd,
Randy Dilworth

5 REPLACED PER ADDENDUM No. 5 DATED FEBRUARY 11, 2019

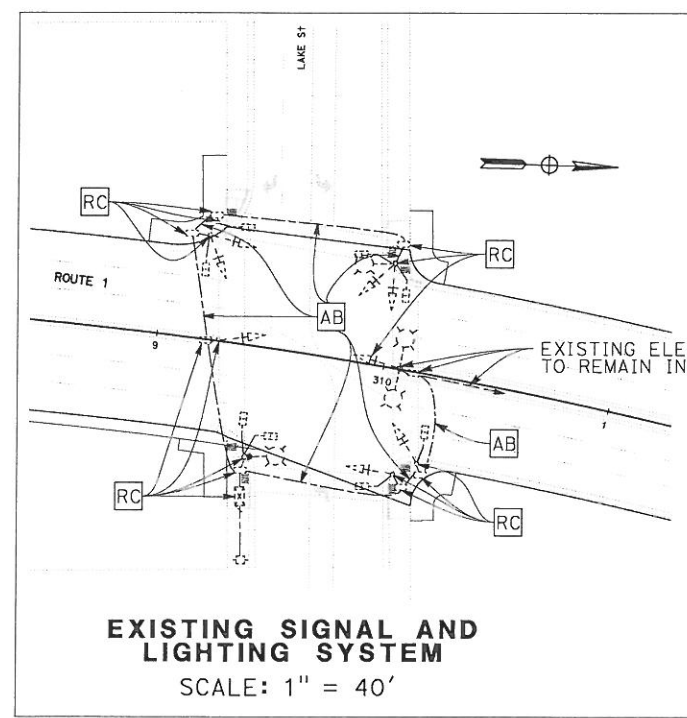
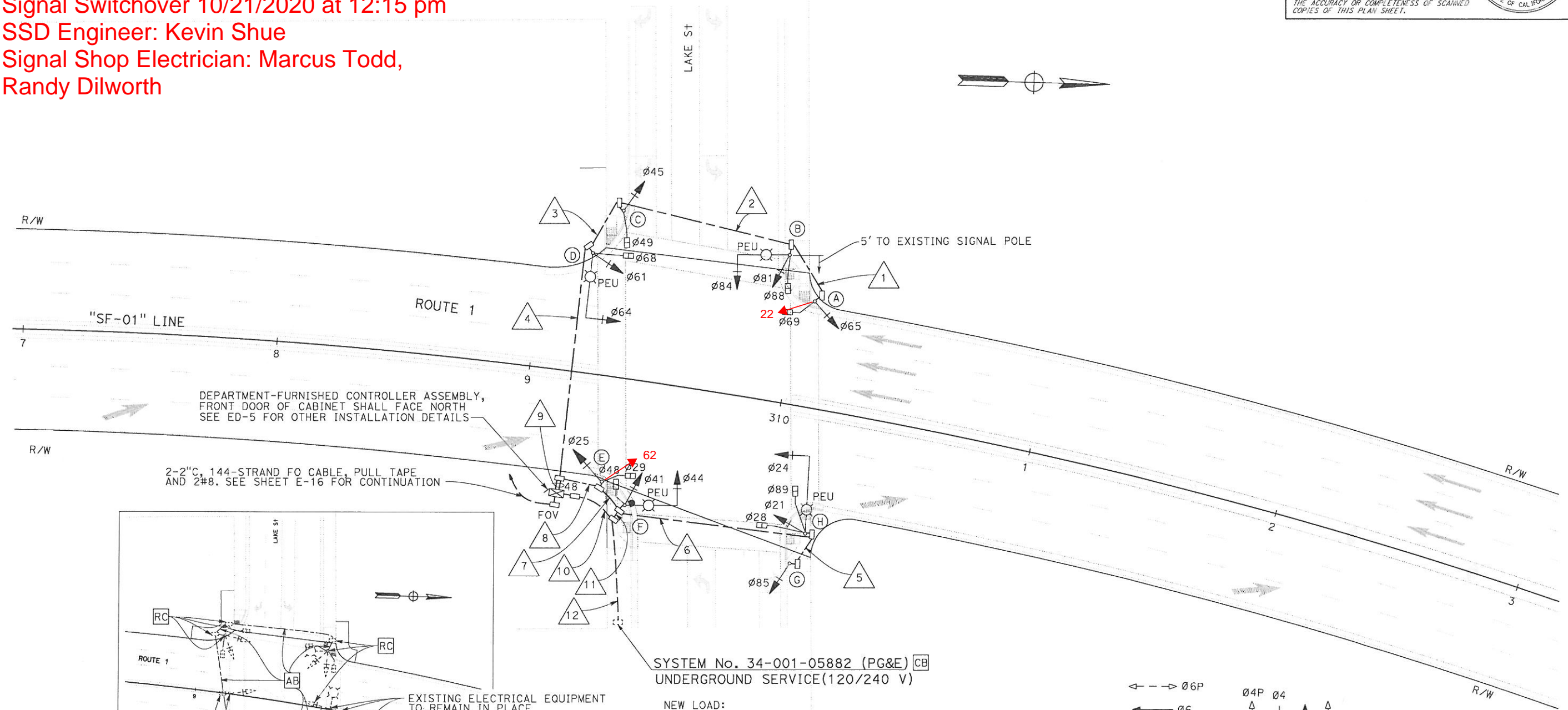

SYSTEM No. 34-001-05882 (PG&E) CB
UNDERGROUND SERVICE(120/240 V)
NEW LOAD:
4-165 W LED LUMINAIRES
1500 W TRAFFIC SIGNAL

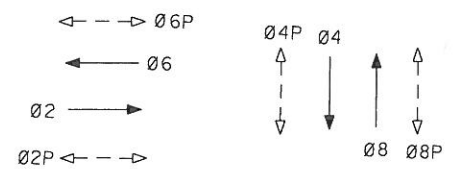

PHASE DIAGRAM

MODIFYING EXISTING ELECTRICAL SYSTEM
SCALE: 1" = 20'

APPROVED FOR ELECTRICAL WORK ONLY

FOR NOTES, ABBREVIATIONS
AND LEGEND, SEE SHEET E-1

E-7

