

T:\I.E. FILES\Signal Design\Van Ness BR\Signal Design\CADD\ CPT8401ETBS - 100% Rev. 3-3-21.dwg KKWONG Tue Mar 09,2021 - 12:14 pm  
BORDER REVISED 11/17/05

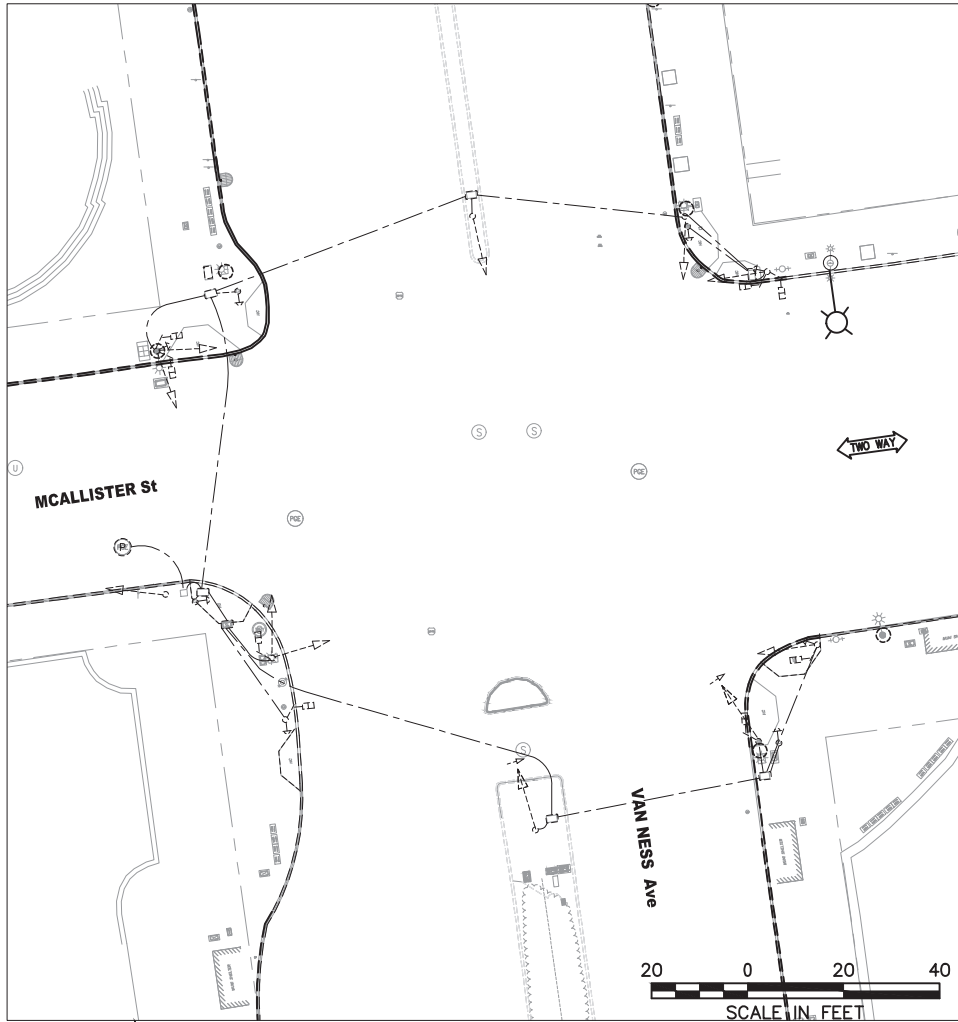

EXISTING EQUIPMENT

DETAIL NOTES:

- 1 THE CONTRACTOR SHALL CONTACT CLEAR CHANNEL TO RELOCATE NEWSPAPER RACKS TO INSTALL TRAFFIC SIGNAL CABINET.

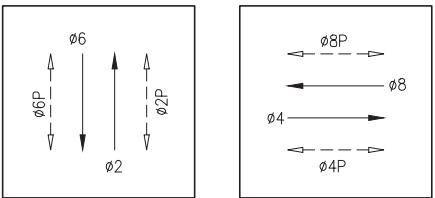

PHASE DIAGRAM

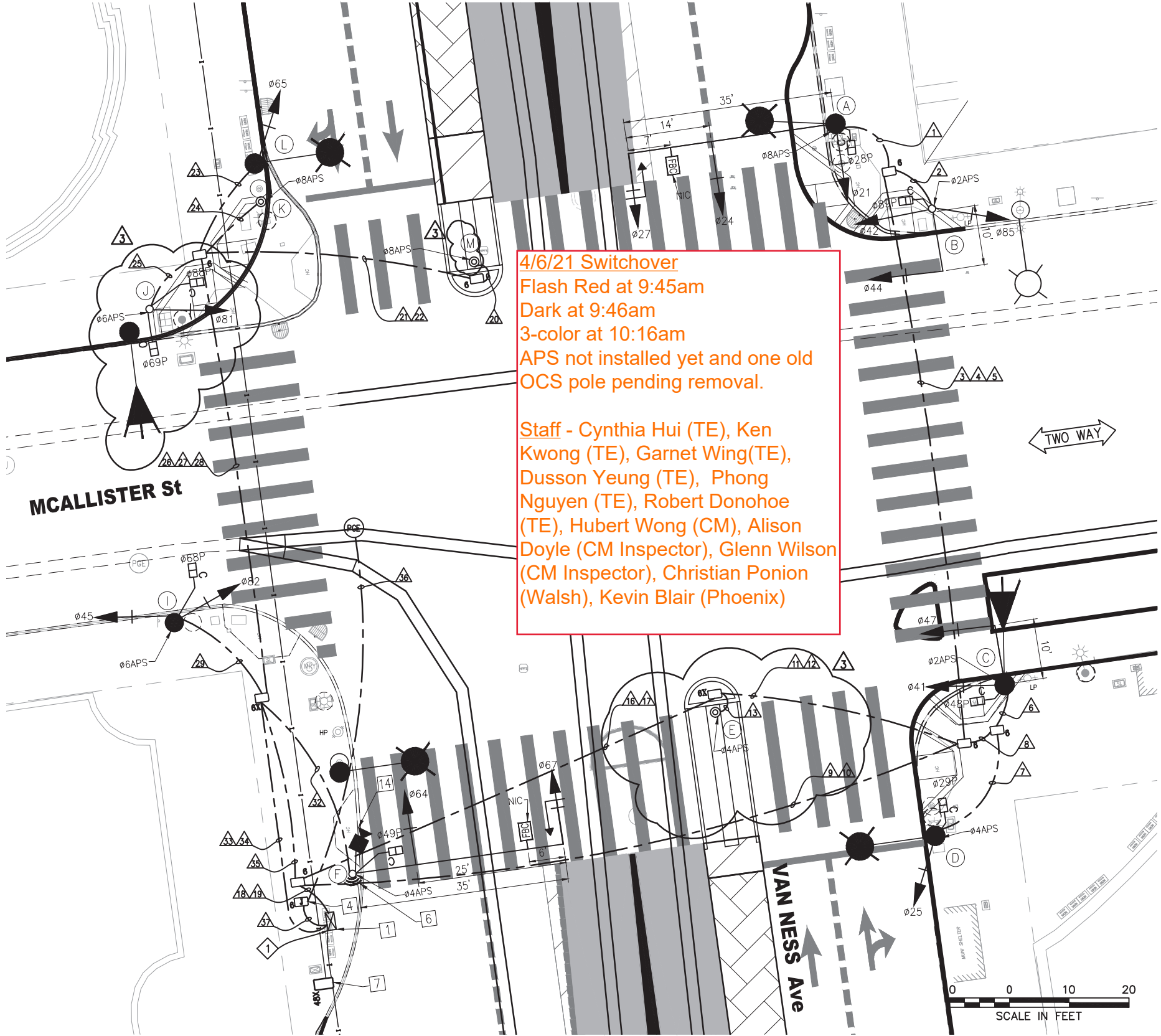

4/6/21 Switchover  
Flash Red at 9:45am  
Dark at 9:46am  
3-color at 10:16am  
APS not installed yet and one old OCS pole pending removal.

Staff - Cynthia Hui (TE), Ken Kwong (TE), Garnet Wing(TE), Dusson Yeung (TE), Phong Nguyen (TE), Robert Donohoe (TE), Hubert Wong (CM), Alison Doyle (CM Inspector), Glenn Wilson (CM Inspector), Christian Ponion (Walsh), Kevin Blair (Phoenix)

FOR ORIGINAL SIGNATURES, SEE ET-106.0, REV 0

3	11/10/20	CONFORMED SET: UPDATED W/ RFI#552 REVISED & #932	KK	MV	CL
2	7/18/19	LATEST DRAWING	KK	MV	CL
SK	11/2/18	POLE LAYOUT: ADJUSTED POLE B; COMBINED POLES F & G, H & I, AND J WITH OCS POLE; REMOVED SIGNAL 61.	KK	MV	CL
1	03/2018	ADDED FBC SIGNS ON POLES A AND G; REMOVED BBS; ADDED TYPE 6X PULLBOXES	KK	MV	CL
NO.	DATE	DESCRIPTION	DESIGNED	CHECKED	APPROVED
REVISIONS					

DESIGNED	K. KWONG
DRAWN	K. KWONG
CHECKED	R. ZAMORA/C. LIU
REVIEWED	C. LIU
RECOMMENDED	P. WILSON
APPROVED	R. OLEA
DATE	12/4/2015



CITY AND COUNTY OF SAN FRANCISCO  
MUNICIPAL TRANSPORTATION AGENCY

APPROVED

for the DIRECTOR OF TRANSPORTATION

MUNI BUS RAPID TRANSIT SYSTEM  
VAN NESS CORRIDOR TRANSIT IMPROVEMENT PROJECT

MCALLISTER STREET  
TRAFFIC SIGNAL WORK

1289

ET-106.0

ET-204

REVISION

3

POLE AND EQUIPMENT SCHEDULE													
POLE NO.	POLE STANDARD			VEHICLE SIGNAL					PEDESTRIAN SIGNAL			HPS LUMINAIRE (WATTS)	SPECIAL REQUIREMENTS
	TYPE	SIG. MA (FEET)	OCs SL	No.	TYPE	MOUNTING	VISORS	LOUVERS	No.	TYPE	MOUNTING		
(A)	SIGNAL, SL & OCS COMBO POLE	35	500 52	21 24 27	3S12" 3S12" 3S12"GUA	SV-1-T MAS MAS	T T T		28	1S-COUNT	SP-1	-	STRAIGHT HORIZONTAL SIGNAL MA MOUNT AT 21' HIGH SEE ST PLANS FOR POLE DETAILS APS ① TENON FOR FUTURE FBC MIDWAY BETWEEN MAS SIGNALS MOUNT SIGNAL 27 BETWEEN YELLOW AND GREEN ③
(B)	16-1-100	10		44 42 85	3S12" 3S12" 3S12"	MAS SV-2-TA	T T T		89	1S-COUNT	SP-1	-	APS ①
(C)	SIGNAL, SL & OCS COMBO POLE	10	499 47	41 47	3S12" 3S12"	SV-1-T MAS	T T		48	1S-COUNT	SP-1	-	SIGNAL MA AT 17'6" CALTRANS MOUNTING HEIGHT ③ APS ①
(D)	SIGNAL, SL & OCS COMBO POLE	-	486 48	25	3S12"	SV-1-T	T		29	1S-COUNT	SP-1	-	APS ①
(E)	PPBP POLE	-		-	-	-	-		-	-	-	-	APS ①
(F)	SPECIAL MAST ARM POLE (23-4-100)	35		64 67	3S12" 3S12"GUA ③	MAS MAS	T T		49	1S-COUNT	SP-1	-	STRAIGHT HORIZONTAL SIGNAL MA MOUNT AT 23.5' HIGH APS ① TSP ② TRAFFIC CAMERA ③, POLE CAP TENON FOR FUTURE FBC 6' FROM END OF MAST ARM MOUNT SIGNAL 67 BETWEEN YELLOW AND GREEN ③
(G)	NOT USED	-		-	-	-	-		-	-	-	-	
(H)	NOT USED	-		-	-	-	-		-	-	-	-	
(I)	SIGNAL & OCS COMBO POLE	-	507	45 82	3S12" 3S12"	SV-2-TA	T T		68	1S-COUNT	SP-1-SF	-	APS ①
(J)	1-A (10')	-	③	81	3S12"	TV-1-T ③	T		69 88	1S-COUNT 1S-COUNT	SP-1-SF(12") SP-1(22")	-	APS ①
(K)	PPBP POLE	-		-	-	-	-		-	-	-	-	APS ①
(L)	NEW SL (TYPE 15TS) ③	-	51	65	3S12"	SV-1-T	T		-	-	-	-	
(M)	PPBP POLE	-		-	-	-	-		-	-	-	-	APS ①

\*OTHER REQUIREMENTS ARE COVERED BY NOTES, LEGEND, SPECIAL PROVISIONS, AND STANDARD SPECIFICATIONS.  
FOR TYPE OF STANDARD, VEHICLE AND PEDESTRIAN SIGNAL MOUNTING, SEE CALTRANS STANDARD PLANS OR DETAIL DRAWINGS.

- ① INSTALL APS WIRING AS SHOWN IN CONDUIT AND WIRING SCHEDULE. CITY FORCES TO INSTALL CITY FURNISHED APS UNIT.
- ② INSTALL CITY FURNISHED TSP WIRING FROM TS OR COMBINED POLES WITH 3 FEET OF SLACK TO TS CABINET.
- ③ INSTALL CITY FURNISHED TRAFFIC CAMERA AND CONTRACTOR FURNISHED WIRING.
- ④ FOR STREETLIGHT WORK, SEE SL-SERIES PLANS.

FOR ORIGINAL SIGNATURES, SEE ET-106.1, REV 0

NO.	DATE	DESCRIPTION	REVISED	CHECKED	APPROVED
3	11/10/20	CONFIRMED SET: UPDATED W/ RF#97, 429, 552R, & 998	KK	MV	CL
2	7/18/19	LATEST DRAWING	KK	MV	CL
SK	11/2/18	POLE LAYOUT: COMBINED POLES F & G, H & I, AND J WITH OCS POLE; REMOVED SIGNAL 61.	KK	MV	CL
1	03/2018	UPDATED POLE STANDARD AND SPECIAL REQUIREMENT; UPDATED POLES A, F, AND G; ADDED FBC TENON NOTE	KK	MV	CL

DESIGNED	K. KWONG
DRAWN	K. KWONG
CHECKED	R. ZAMORA/C. LIU
REVIEWED	C. LIU
RECOMMENDED	P. WILSON
APPROVED	R. OLEA
DATE	12/4/2015



CITY AND COUNTY OF SAN FRANCISCO  
**MUNICIPAL TRANSPORTATION AGENCY**

APPROVED

for the DIRECTOR OF TRANSPORTATION

MUNI BUS RAPID TRANSIT SYSTEM VAN NESS CORRIDOR TRANSIT IMPROVEMENT PROJECT	1289	
McALLISTER STREET CONDUCTOR POLE AND EQUIPMENT SCHEDULES	ET-106.1	REVISION
	ET-204	3

3

3

 $\triangle 3$ 

DESIGNED	<b>K. KWONG</b>
DRAWN	<b>K. KWONG</b>
CHECKED	<b>R. ZAMORA/C. LIU</b>
REVIEWED	<b>C. LIU</b>
RECOMMENDED	<b>P. WILSON</b>
APPROVED	<b>R. OLEA</b>
DATE	<b>12/4/2015</b>



APPROVED

for the DIRECTOR OF TRANSPORTATION

1289

ET-204

## REVISION

3