

5/4/21 Traffic Signal Switchover  
8:55am Dark, 9:18am Emergency Flash, 9:24am 3-color. APS  
not installed yet.

Staff  
Ken Kwong (TE), Phong Nguyen (Signal Shop), Danny Guevara  
(Signal Shop), Glenn Wilson (CPC), Cameron Peters (Phoenix),  
Wilson Lew (Phoenix)

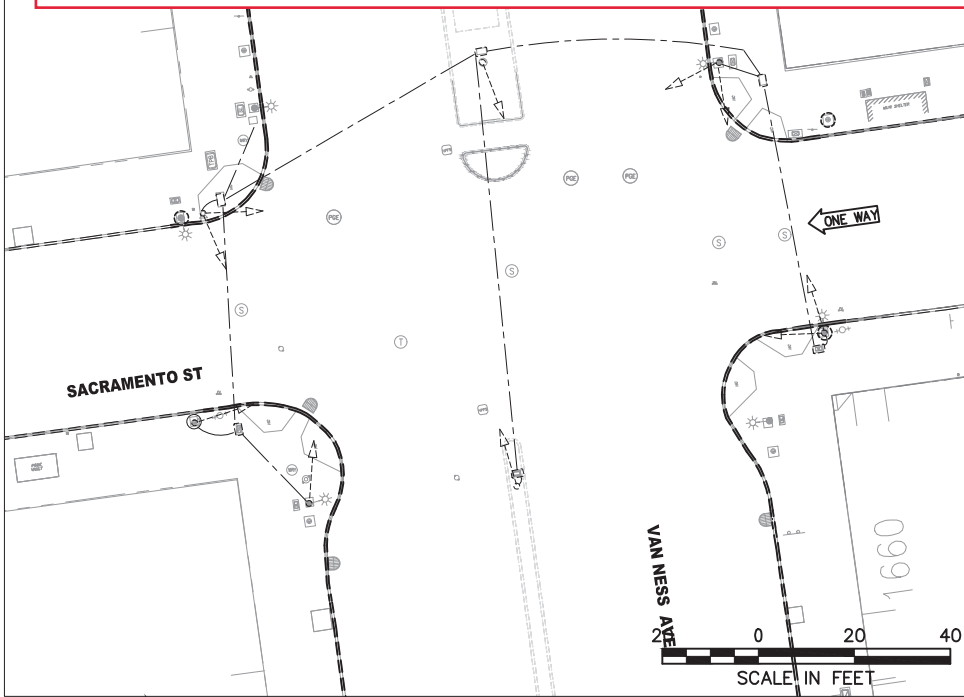

EXISTING EQUIPMENT

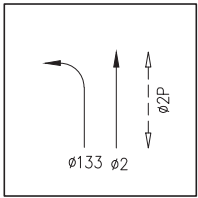
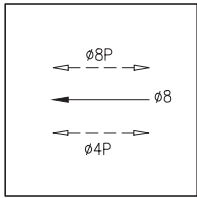
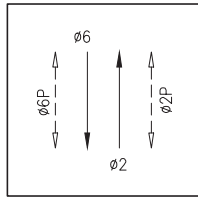

PHASE DIAGRAM

FOR ORIGINAL SIGNATURES, SEE ET-118.0, REV 0

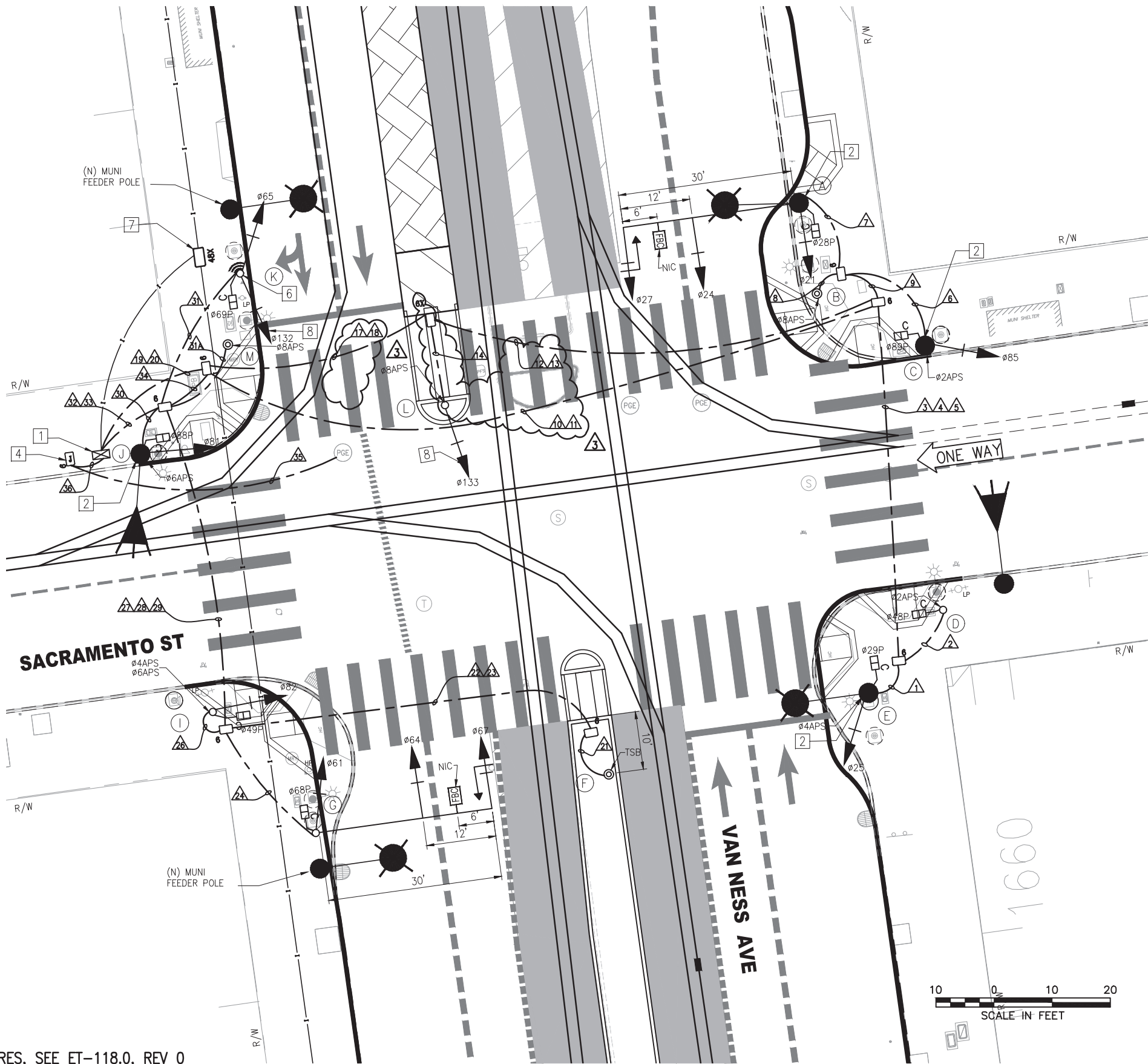

I:\T.E. FILES\SP\Projects\Van Ness BRT\Signal Design\CADD\ CPTB401ETBS - 100% Rev. 3-3-21.dwg KKWONG Tue Mar 09,2021 - 12:16 pm

3	11/10/20	CONFORMED SET: UPDATED W/RFI #932	KK	MV	CL
2	7/18/19	LATEST DRAWING	KK	MV	CL
SK	4/9/19	RFI #620: REMOVED POLE H; TWO APS ON POLE I; NEW PPB POLE M PER POLE LAYOUT.	KK	MV	CL
1	03/2018	ADDED FBC SIGNS ON POLES A AND G, UPDATED POLE A MA LENGTH; ADDED TYPE 6X PULLBOX	KK	MV	CL
NO.	DATE	DESCRIPTION	REVISED	CHECKED	APPROVED
REVISIONS					

DESIGNED	K. KWONG
DRAWN	K. KWONG
CHECKED	R. ZAMORA/G. LIU
REVIEWED	C. LIU
RECOMMENDED	P. WILSON
APPROVED	R. OLEA
DATE	12/4/2015



CITY AND COUNTY OF SAN FRANCISCO  
MUNICIPAL TRANSPORTATION AGENCY

APPROVED

for the DIRECTOR OF TRANSPORTATION

MUNI BUS RAPID TRANSIT SYSTEM  
VAN NESS CORRIDOR TRANSIT IMPROVEMENT PROJECT

SACRAMENTO STREET  
TRAFFIC SIGNAL WORK

1289

ET-118.0

ET-204

REVISION

3

F:\T.E. FILES\Spa\Projects\Van Ness BR\Signal Design\CADD\ CPTB401ETBS - 100% Rev. 3-3-21.dwg KKWONG Tue Mar 09,2021 - 12:16 pm

POLE AND EQUIPMENT SCHEDULE													
POLE NO.	POLE STANDARD			VEHICLE SIGNAL					PEDESTRIAN SIGNAL			HPS LUMINAIRE (WATTS)	SPECIAL REQUIREMENTS
	TYPE	SIG. MA (FEET)	OCS SL	No.	TYPE	MOUNTING	VISORS	LOUVERS	No.	TYPE	MOUNTING		
(A)	SIGNAL, SL & OCS COMBO POLE	30	1704 172	21 24 27	3S12" 3S12" 3S12"GUA	SV-1-T MAS MAS	T T T		28	1S-COUNT	SP-1	-	STRAIGHT HORIZONTAL SIGNAL MA MOUNT AT 21' HIGH SEE ST PLANS FOR POLE DETAILS TENON FOR FUTURE FBC MIDWAY BETWEEN MAS SIGNALS
(B)	PPBP POLE	-		-	-	-	-		-	-	-	-	APS 1
(C)	SIGNAL & OCS COMBO POLE	-	1798	85	3S12"	SV-1-T	T		89	1S-COUNT	SP-1	-	APS 1
(D)	1-A (7')	-		-	-	-	-		48	1S-COUNT	TP-1	-	APS 1
(E)	SIGNAL, SL & OCS COMBO POLE	-	1694 168	25	3S12"	SV-1-T	T		29	1S-COUNT	SP-1	-	APS 1
(F)	TSB POLE	-		-	-	-	-		-	-	-	-	TSB
(G)	SPECIAL MAST ARM POLE (18-4-100)	30		61 64 67	3S12" 3S12" 3S12"GUA	SV-1-T MAS MAS	T T T		68	1S-COUNT	SP-1	-	STRAIGHT HORIZONTAL SIGNAL MA MOUNT AT 21' HIGH TENON FOR FUTURE FBC MIDWAY BETWEEN MAS SIGNALS
(H)	NOT USED	-		-	-	-	-		-	-	-	-	
(I)	1-A (10')			82	3S12"	TV-1-T	T		49	1S-COUNT	SP-1	-	APS x2 1
(J)	SIGNAL, SL & OCS COMBO POLE	-	1802 182	81	3S12"	SV-1-T	T		88	1S-COUNT	SP-1	-	APS 1
(K)	1-A (10')	-		65 132	3S12" 3S12"LB	TV-2-T	T T		69	1S-COUNT	SP-1	-	APS 1 TSP 2 3
(L)	1-A (10')			133	3S12"LB	TV-1-T	T						APS 1
(M)	PPB POLE	-		-	-	-	-		-	-	-	-	APS 1

MOUNT SIGNAL 27 BETWEEN YELLOW AND GREEN 3

MOUNT SIGNAL 67 BETWEEN YELLOW AND GREEN 3

\*OTHER REQUIREMENTS ARE COVERED BY NOTES, LEGEND, SPECIAL PROVISIONS, AND STANDARD SPECIFICATIONS.  
FOR TYPE OF STANDARD, VEHICLE AND PEDESTRIAN SIGNAL MOUNTING, SEE CALTRANS STANDARD PLANS OR DETAIL DRAWINGS.

- 1 INSTALL APS WIRING AS SHOWN IN CONDUIT AND WIRING SCHEDULE. CITY FORCES TO INSTALL CITY FURNISHED APS UNIT.  
2 INSTALL CITY FURNISHED TSP WIRING FROM TS OR COMBINED POLES WITH 3 FEET OF SLACK TO TS CABINET.  
3 INSTALL CITY FURNISHED TRAFFIC CAMERA AND CONTRACTOR FURNISHED WIRING.  
4 FOR STREETLIGHT WORK, SEE SL-SERIES PLANS.

FOR ORIGINAL SIGNATURES, SEE ET-118.1, REV 0

3	11/10/20	CONFORMED SET AND UPDATED W/RFI #998	KK	MV	CL
2	7/18/19	LATEST DRAWING	KK	MV	CL
SK	4/9/19	RFI #620: REMOVED POLE H; TWO APS ON POLE I; NEW PPB POLE M PER POLE LAYOUT.	KK	MV	CL
1	03/2018	UPDATED POLE STANDARD AND SPECIAL REQUIREMENT, UPDATED POLES A AND G	KK	MV	CL
NO.	DATE	DESCRIPTION	REVISED	CHECKED	APPROVED
REVISIONS					

DESIGNED	K. KWONG
DRAWN	K. KWONG
CHECKED	R. ZAMORA/G. LIU
REVIEWED	C. LIU
RECOMMENDED	P. WILSON
APPROVED	R. OLEA
DATE	12/4/2015



CITY AND COUNTY OF SAN FRANCISCO  
MUNICIPAL TRANSPORTATION AGENCY

APPROVED

for the DIRECTOR OF TRANSPORTATION

MUNI BUS RAPID TRANSIT SYSTEM  
VAN NESS CORRIDOR TRANSIT IMPROVEMENT PROJECT

1289

SACRAMENTO STREET  
CONDUCTOR POLE AND EQUIPMENT SCHEDULES

ET-118.1

ET-204

REVISION

3

2

2

for the DIRECTOR OF TRANSPORTATION

## REVISION