

New signals activated at  
10:01A, 5-7-2013. GH

POLE AND EQUIPMENT SCHEDULE											CONTRACT WORK IN BOLD
POLE No.	TYPE OF POLE	LUMINAIRE VOLTAGE/WATTAGE	VEHICLE SIGNAL					PEDESTRIAN SIGNAL			REMARKS
			No.	TYPE	MOUNTING	VISORS	LOUVERS	No.	TYPE	MOUNTING	
①	1-A (10')		21	3S12"	TV-1-T	T		28	1S-COUNT	SP-1	<b>NON-ACTUATED</b> APS ②
②	<b>CITY STANDARD</b> <del>1-A (10')</del> <b>Street Light</b>		42	3S12"	<del>TV-1-T</del> <b>SV-1-T</b>	T		89	1S-COUNT	SP-1	<b>NON-ACTUATED</b> APS ②
③	1-A (10')		41	3S12"	TV-1-T	T		48	1S-COUNT	SP-1	<b>NON-ACTUATED</b> APS ②
④	1-A (7')							29	1S-COUNT	TP-1	<b>NON-ACTUATED</b> APS ②
⑤	EX MARBELITE SL W/ DUAL LUMINAIRE ARMS		63	3S12"	SV-1-T	T					
⑥	1-A (10')		61	3S12"	TV-1-T	T		68	1S-COUNT	SP-1	<b>NON-ACTUATED</b> APS ②
⑦	1-A (10')		82	3S12"	TV-1-T	T		49	1S-COUNT	SP-1	<b>NON-ACTUATED</b> APS ②
⑧	<b>CITY STANDARD</b> <b>STREET LIGHT</b>	120V/150W	81	3S12"	SV-1-T	T		88	1S-COUNT	SP-1	<b>NON-ACTUATED</b> APS ② ⑤
⑨	1-A (7')							69	1S-COUNT	TP-1	<b>NON-ACTUATED</b> APS ②
⑩	EX MARBELITE SL W/ DUAL LUMINAIRE ARMS		23	3S12"	SV-1-T	T					

#### SHEET NOTES:

- CONTRACTOR TO REMOVE AND SALVAGE EXISTING INTERSECTION CONTROLLER CABINET AND REMOVE AS CONTRACTOR'S PROPERTY EXISTING CONTROLLER FOUNDATION. RESTORE SIDEWALK TO MATCH EXISTING CONDITIONS.
- CITY FORCES TO INSTALL CITY FURNISHED APS BUTTONS ON POLES AS SHOWN ON INTERSECTION DRAWING AND AS INDICATED IN POLE & EQUIPMENT SCHEDULE. CONTRACTOR TO INSTALL APS WIRING AS INDICATED IN CONDUIT AND WIRING SCHEDULE.
- CONTRACTOR TO INSTALL CITY FURNISHED INTERSECTION SIGNAL CONTROLLER CABINET
- EXTEND EXISTING 12C TO NEW CONTROLLER. SPLICE NEW 12C TO EXISTING 12C TO MAINTAIN INTERCONNECT SYSTEM.
- SPLICE NEW STREET LIGHT WIRING TO LINE SIDE OF SERVICE WIRING. ~~CONTRACTOR TO VERIFY EXISTING VOLTAGE.~~
- SEE CR-03 REGARDING RELOCATION OR READJUSTMENT OF EXISTING TS PULL BOX. AFTER ACTIVATION OF NEW TS WIRING, CUT CONDUIT(S) FOR OLD TS WIRING FLUSH TO PULL BOX WALL (EXCEPT AS NOTED) AND CAP END(S). MAINTAIN ANY EXISTING 12C WIRING AND CONDUITS.
- IC SERVICE POINT WILL BE A PG&E WOOD UTILITY POLE LOCATED APPROXIMATELY 20' EAST FROM THE SOUTHEAST CORNER OF THE SUNSET/VICENTE PROPERTY LINE. F/I TYPE 1 PULL BOX NEXT TO THIS PG&E SERVICE POINT WOOD POLE. COORDINATE WITH PG&E FOR FINAL POWER SERVICE CONNECTION. **PG&E Distribution**
- REMOVE PORTION OF EXISTING 12C EXTENDING TO OLD SIGNAL CONTROLLER LOCATION WHILE MAINTAINING EXISTING INTERCONNECT SYSTEM.
- AFTER ACTIVATION OF NEW TS WIRING, REMOVE EXISTING PULL BOX. CUT CONDUIT(S) FLUSH TO PULL BOX WALL (EXCEPT AS NOTED) AND CAP END(S). RESTORE SIDEWALK TO MATCHING EXISTING

#### PHASE DIAGRAM

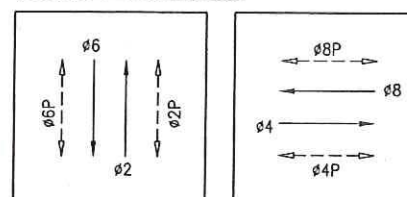

#### PHASE SEQUENCE

G	Y	R	SUNSET BLVD (NB & SB) - ② & ⑥
R	G	Y R	VICENTE ST (EB & WB) - ④ & ⑧
WM	FRH	RH	PED XING VICENTE ST (ES & WS) - ②P & ⑥P
RH	WM	FRH RH	PED XING SUNSET BLVD (SS & NS) - ④P & ⑧P

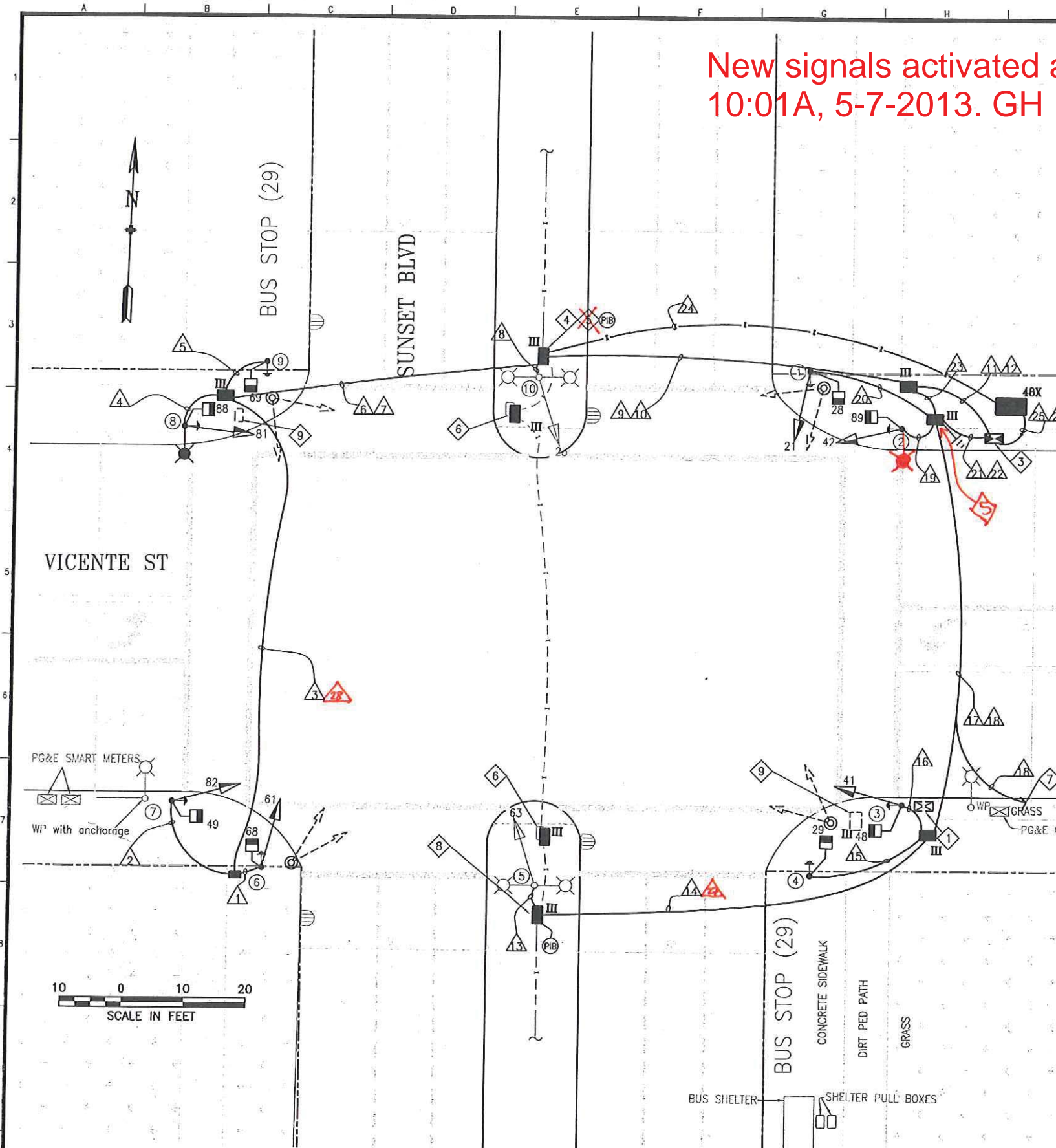

NO.	DATE	DESCRIPTION	BY	APP

REFERENCE INFORMATION  
& FILE NO. OF SURVEYS



**INFRASTRUCTURE DIVISION**  
DEPARTMENT OF PUBLIC WORKS



DESIGNED: DATE: 2/3/12  
GD  
DRAWN: DATE: 2/3/12  
GD  
APPROVED: AUG 15 2012  
SECTION MANAGER  
DEPUTY DIVISION MANAGER

SCALE:  
AS SHOWN  
SHEET OF SHEETS

**SUNSET BOULEVARD**  
**PEDESTRIAN COUNTDOWN SIGNALS PROJECT**  
**VICENTE STREET AND SUNSET BOULEVARD**

CONTRACT NO.  
1984J  
DRAWING NO.  
E-4.0  
FILE NO.

Xrefs: T:\T\_E\_FILES\Special Projects & Street Use\Design\Std\Standards\BDE Title Block.dwg  
V:\1984J\_Sunset\_Bldg\_Ped\_Countdown\_Signs\2\_Design\Working\_Drawings\EEL\95\_Submittal\Sunset\_Striping.dwg  
V:\1984J\_Sunset\_Bldg\_Ped\_Countdown\_Signs\2\_Design\Working\_Drawings\EEL\95\_Submittal\B053\_TBD.dwg  
Log in: mwu  
Model Units: Undefined  
Measurement Units are English



CONDUIT AND WIRING SCHEDULE (FURNISH AND INSTALL CONDUIT AND WIRES)

	1	2	3	4	5	6	7	8	9	10	11	12	13	14	15	16	17	18	19	20	21	22	23	24	25	26			
CONDUIT SIZE (INCH)	2	2	2	2	2	2	2	2	2	2	3	2	2	2	2	2	2	2	2	2	3	2	2	2	2	2			
							SP	EX		SP		SP	EX																
NOTES																													
VEHICLE SIGNAL 61	3		3			3			3	3																			
PED SIGNAL 68	2		2			2			2	2																			
VEHICLE SIGNAL 82		3	3			3			3	3																			
PED SIGNAL 49		2	2			2			2	2																			
VEHICLE SIGNAL 81				3		3			3	3																			
PED SIGNAL 88				2		2			2	2																			
PED SIGNAL 69					2	2			2	2																			
VEHICLE SIGNAL 23								3	3	3																			
VEHICLE SIGNAL 63												3	3				3				3								
PED SIGNAL 29														2			2				2								
VEHICLE SIGNAL 41																3	3				3								
PED SIGNAL 48														2	2						2								
VEHICLE SIGNAL 42																			3		3								
PED SIGNAL 89																		2			2								
VEHICLE SIGNAL 21																				3	3								
PED SIGNAL 28																				2	2								
#14 NEUTRAL	2	2		2	1			1					1		1	2			2	2									
#14 SPARE			3			3		3		3			3			3					3								
TOTAL #14 WIRES	7	7	13	7	3	20		4	23	23		4	6	3	7	13			7	7	23								
#10 WIRES NEUTRAL			1			2		3		3			1			2					3								
#10 WIRES STREET LIGHT				2															2										
#8 WIRES STREET LIGHT						2		<del>2</del>	2												2								
#8 WIRES (120 V SERVICE)								0									2				2								
#6 BSCW (SEE SHEET NOTE 1)																													
INTERCONNECT 12C CABLE																							2	2					
INSTALL CITY FURNISHED 4 WIRE BELDEN 8489 (OR EQUIVALENT) FOR LOCATIONS BELOW:																													
APS PPB ON POLE 1 (PULL TO P.S. 89 ON POLE 2)																			1	1									
APS PPB ON POLE 2 (PULL TO P.S. 28 ON POLE 1)																			1	1									
APS PPB ON POLE 3 (PULL TO P.S. 29 ON POLE 4)															1	1													
APS PPB ON POLE 4 (PULL TO P.S. 48 ON POLE 3)															1	1													
APS PPB ON POLE 6 (PULL TO P.S. 49 ON POLE 7)	1	1																											
APS PPB ON POLE 7 (PULL TO P.S. 68 ON POLE 6)	1	1																											
APS PPB ON POLE 8 (PULL TO P.S. 69 ON POLE 9)				1	1																								
APS PPB ON POLE 9 (PULL TO P.S. 88 ON POLE 8)				1	1																								

SHEET NOTES:

1 F/I 4-2" POLYETHYLENE SCHEDULE 80 CONDUIT WITH 3/8" PULL TAPE. IN ONE OF THE EMPTY CONDUITS, INSTALL TWO #8 AWG STRANDED COPPER LOCATING WIRES (ONE WITH BLACK INSULATION AND THE OTHER WITH WHITE INSULATION). SEE SECTION 34 41 13 IN CONTRACT SPECIFICATIONS.

REFERENCE INFORMATION  
& FILE NO. OF SURVEYS



INFRASTRUCTURE DIVISION  
DEPARTMENT OF PUBLIC WORKS



DESIGNED: DATE: 02/03/12  
GD  
DRAWN: DATE: 02/03/12  
GD  
APPROVED: DATE: AUG 15 2012  
SECTION MANAGER  
DEPUTY DIVISION MANAGER DATE:

SCALE:  
NO SCALE  
SHEET OF SHEETS

SUNSET BOULEVARD  
PEDESTRIAN COUNTDOWN SIGNALS PROJECT  
VICENTE STREET AND SUNSET BOULEVARD



CONTRACT NO.  
1984J  
DRAWING NO.  
E-4.1  
FILE NO.  
04 677

ath: V:\1984J\_Sunset\_Bvd\_Ped\_Countdown\_Signal\2\_Design\Working\_Drawings\EEL\100\_Submittal\1984J\_E-0404\0404.dwg, Login: mwu  
Thu, 26 Jul 2012 - 3:13pm  
Model Units: Undefined  
Measurement Units are English  
Xrefs: T:\E-FILES\Special Projects & Street Use\Design\_Side\CADD\_Standards\806 Title Block.dwg  
V:\1984J\_Sunset\_Bvd\_Ped\_Countdown\_Signal\2\_Design\Working\_Drawings\EEL\95\_Submittal\Sunset Stripping.dwg  
V:\1984J\_Sunset\_Bvd\_Ped\_Countdown\_Signal\2\_Design\Working\_Drawings\EEL\95\_Submittal\95E9\_1B0.dwg